

MACK

15" "Q PLUS" SPECIAL CLEARANCE FRONT BRAKE, ROCKWELL DESIGN

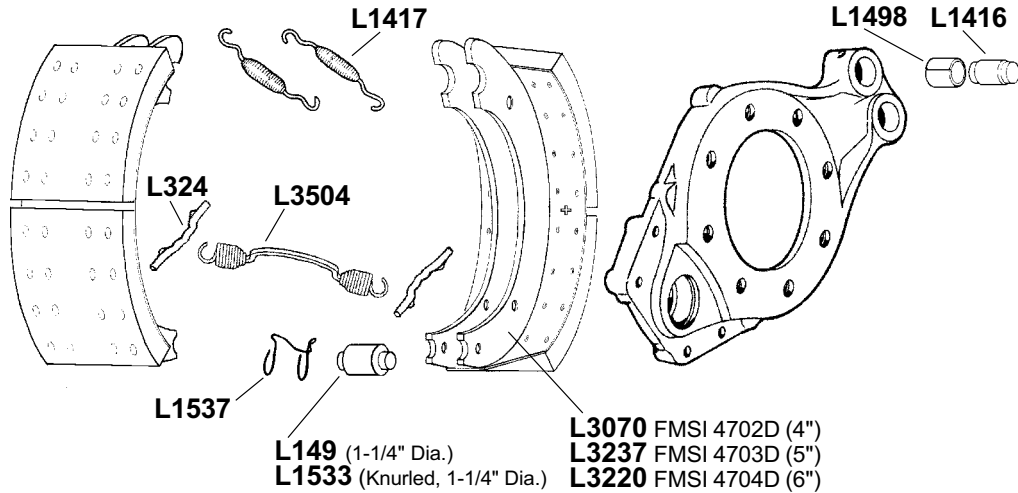
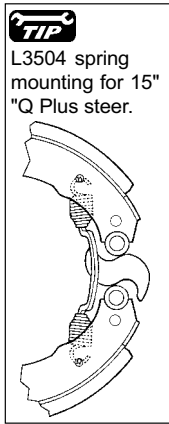

K504 with L149 Smooth Rollers.

Brake Repair Kits: **K504K** with L1533 Knurled Rollers.

MACK 15" CAMSHAFT IDENTIFICATION

15" "Q-Plus" Brakes
1-1/2" Dia., 28 Spline

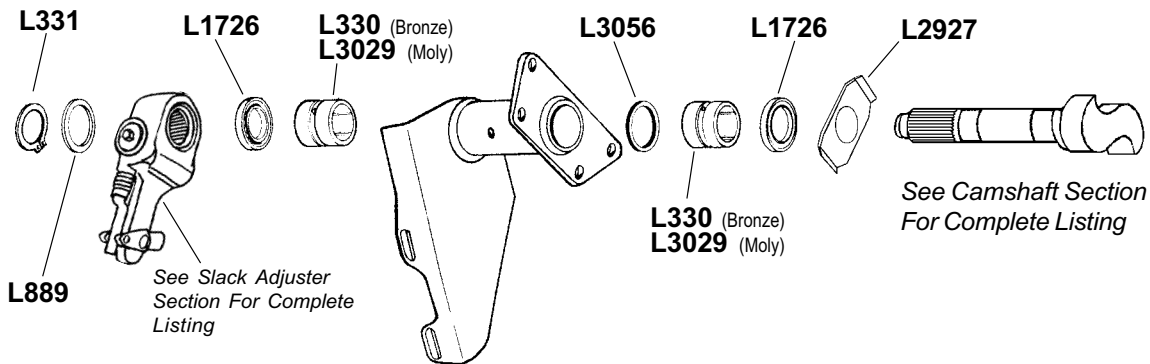
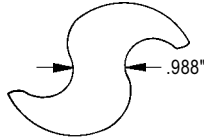

Cam Repair Kits:

K81 - Axle, with L3029 Molydisulfide bushings.

K48 - Wheel, with L3029 Molydisulfide bushings.



Heavy Duty Version:

K351 - Axle, with L330 Bronze bushings

K365 - Wheel, with L330 Bronze bushings



Heavy Duty Version

Schematic
Diagram
Charts
4

**M
A
C
K**

BRAKE REPAIR KITS

MACK

K504

For 15" Q-Plus Steer Axle using Special Clearance Return Spring and L149 Smooth Cam Roller

Contains:

- 2 Pcs. - L149 Smooth Roller
- 2 Pcs. - L324 Return Spring Pin
- 2 Pcs. - L1416 Anchor Pin
- 2 Pcs. - L1417 Retainer Spring
- 2 Pcs. - L1498 Anchor Pin Bushing
- 2 Pcs. - L1537 Roller Retainer
- 1 Pc. - L3504 Return Spring

Contains parts to service one wheel



K504K

For 15" Q-Plus Steer Axle using Special Clearance Return Spring and L1533 Knurled Cam Roller

Contains:

- 2 Pcs. - L324 Return Spring Pin
- 2 Pcs. - L1416 Anchor Pin
- 2 Pcs. - L1417 Retainer Spring
- 2 Pcs. - L1498 Anchor Pin Bushing
- 2 Pcs. - L1533 Knurled Roller
- 2 Pcs. - L1537 Roller Retainer
- 1 Pc. - L3504 Return Spring

Contains parts to service one wheel



Schematic
Diagram
Charts

4

CAM REPAIR KITS

K81

Axle Cam Kit For Rockwell "Q" Drive or Steer Axle 1-1/2"-10 or 28 Spline Cams

Contains:

- 2 Pcs. - L137 Lock Ring
- 2 Pcs. - L192 Spacer Washer
- 2 Pcs. - L193 Spacer Washer
- 4 Pcs. - L329 Neoprene Seal
- 2 Pcs. - L331 Lock Ring
- 2 Pcs. - L889 Spacer Washer
- 2 Pcs. - L2900 Snap Ring
- 2 Pcs. - L2926 Washer
- 2 Pcs. - L2927 Washer
- 4 Pcs. - L3029 Bushing

Contains parts to service one axle.

For one wheel end kit, use **K48**.



K351

Axle Kit For Mack (Rockwell) Heavy Duty "Q" Drive Axle

Contents:

- 2 Pcs. - L137 Lock Ring
- 2 Pcs. - L192 Spacer Washer
- 2 Pcs. - L193 Spacer Washer
- 4 Pcs. - L329 Cam Seal
- 4 Pcs. - L330 Bronze Bushing
- 2 Pcs. - L331 H.D. Lock Ring
- 2 Pcs. - L889 Spline Washer
- 2 Pcs. - L2900 H.D. Lock Ring
- 2 Pcs. - L2926 Cam Head Washer
- 2 Pcs. - L2927 Cam Head Washer

Use **K365** to service One Wheel End

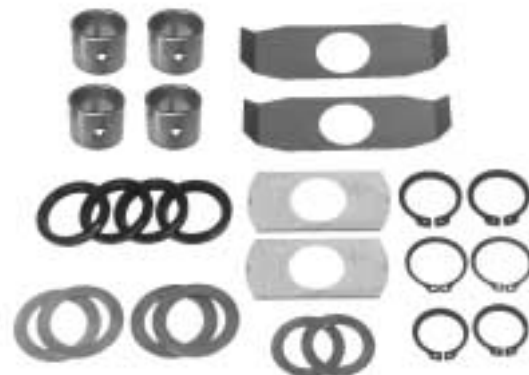

M
A
C
K

MACK

16-1/2" "Q" FRONT BRAKE, ROCKWELL DESIGN

TIP Mack predominately, but also found on some other models; i.e.: Paccar, Volvo White.

Also see Eaton's "High Mount."

TIP L3126 spring mounting for use with "Q Plus" Cams or "claw"

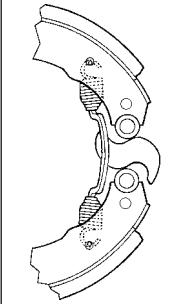

Schematic Diagram Charts
4

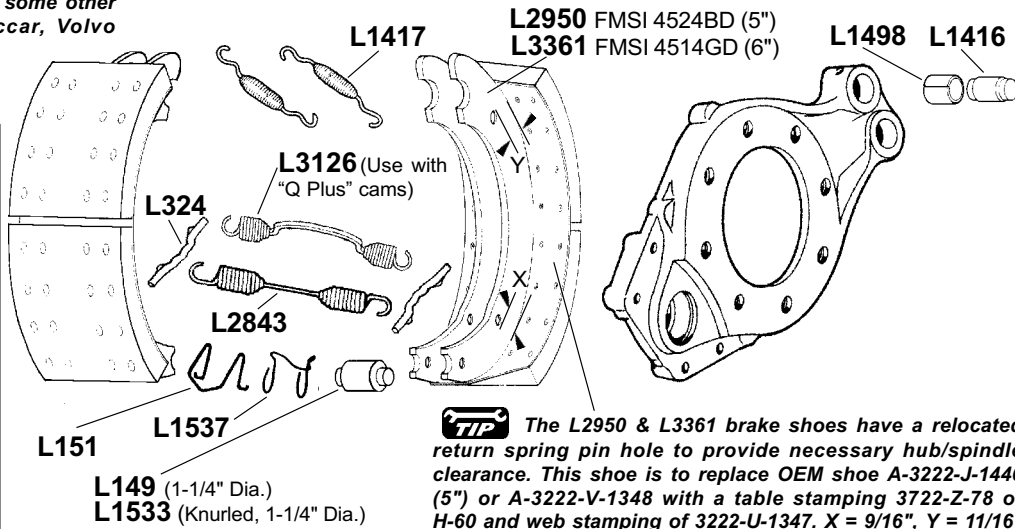

TIP The L2950 & L3361 brake shoes have a relocated return spring pin hole to provide necessary hub/spindle clearance. This shoe is to replace OEM shoe A-3222-J-1440 (5") or A-3222-V-1348 with a table stamping 3722-Z-78 or H-60 and web stamping of 3222-U-1347. X = 9/16", Y = 11/16"

FOR OTHER MACK STEER AXLE BRAKE APPLICATIONS SEE EATON, ROCKWELL AND WAGNER SCHEMATIC SECTIONS.

TIP Do Not Confuse This Application With: OEM shoe A-3222-G-1541 (5") with web stamping 3222-U-1529 and (same) table stamping 3722-Z-78, which has both relocated return and retaining spring holes. X = 3/4", Y = 3/8"

Aftermarket shoes with two return spring pin holes on each web use the upper pin hole nearest to the shoe table to attach the return spring. The lower holes are used for standard FMSI 4524BD applications.

Brake Repair Kits: **K292** Contains L2843 spring for "Claw Head" cam only.

K334 Contains L3126 spring for "Q Plus" or "Claw Head" cam.

Camshafts: "Claw Head" or "Q Plus" type

MACK 16-1/2" CAMSHAFT IDENTIFICATION



"Claw Head", Use either L2843 Return Spring (K292) or L3126 Return Spring, (K334).

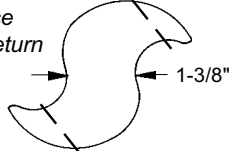

"Q-Plus" Type Use L3126 Return Spring (K334) only

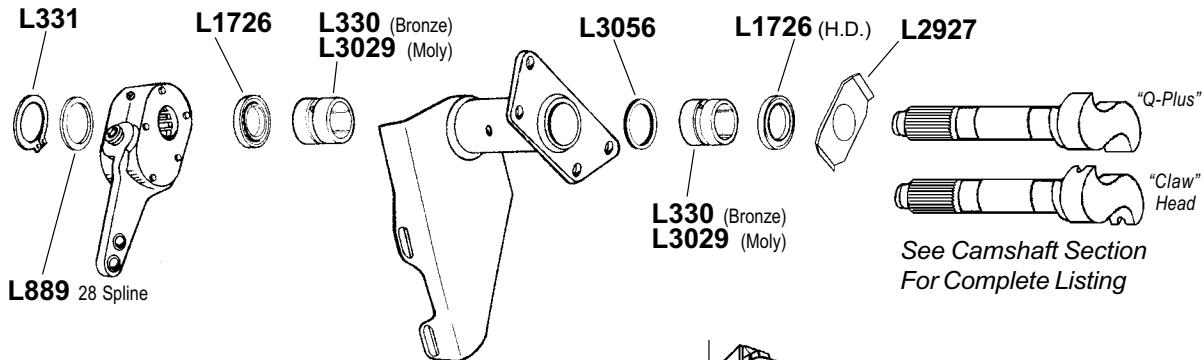
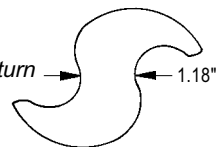

Cam Repair Kits:

K81 - Axle, with L3029 Molydisulfide bushings.

K48 - Wheel, with L3029 Molydisulfide bushings.

Heavy Duty Version:

K351 - Axle, with L330 Bronze bushings

K365 - Wheel, with L330 Bronze bushings

See Camshaft Section For Complete Listing

BRAKE REPAIR KITS

MACK

K292

For Mack (Rockwell)
16-1/2" x 5" "Q" Steering Axle

Contains:

2 Pcs. - L149	Roller
2 Pcs. - L151	Roller Retainer
2 Pcs. - L324	Return Spring Pin
2 Pcs. - L1416	Anchor Pin
2 Pcs. - L1417	Retainer Spring
2 Pcs. - L1498	Anchor Pin Bushing
1 Pc. - L2843	Brake Return Spring

Contains parts to service one wheel.



K334

For Mack (Rockwell) 16-1/2" x 5" or 6"
"Q" Steering Axle using "Q-Plus" Camshafts
and Special Clearance Return Spring

Contents:

2 Pcs. - L149	Roller
2 Pcs. - L151	Roller Retainer
2 Pcs. - L324	Return Spring Pin
2 Pcs. - L1416	Anchor Pin
2 Pcs. - L1417	Retainer Spring
2 Pcs. - L1498	Anchor Pin Bushing
1 Pc. - L3126	Return Spring

Contains parts to service one wheel



Schematic
Diagram
Charts

4

CAM REPAIR KITS

K81

Axle Cam Kit For Mack (Rockwell) "Q" Drive or Steer
Axle 1-1/2"-10 or 28 Spline Cams

Contains:

2 Pc. - L137	Lock Ring
2 Pc. - L192	Spacer Washer
2 Pc. - L193	Spacer Washer
4 Pcs. - L329	Neoprene Seal
2 Pc. - L331	Lock Ring
2 Pc. - L889	Spacer Washer
2 Pc. - L2900	Snap Ring
2 Pc. - L2926	Washer
2 Pc. - L2927	Washer
4 Pcs. - L3029	Bushing

Contains parts to service one axle.

For one wheel end kit, use **K48**.



K351

Axle Kit For Mack (Rockwell)
Heavy Duty "Q" Drive Axle
(Also For other Rockwell Drive and Steer Applications)

Contents:

2 Pcs. - L137	Lock Ring
2 Pcs. - L192	Spacer Washer
2 Pcs. - L193	Spacer Washer
4 Pcs. - L329	Cam Seal
4 Pcs. - L330	Bronze Bushing
2 Pcs. - L331	H.D. Lock Ring
2 Pcs. - L889	Spline Washer
2 Pcs. - L2900	H.D. Lock Ring
2 Pcs. - L2926	Cam Head Washer
2 Pcs. - L2927	Cam Head Washer

Use **K365** to service One Wheel End

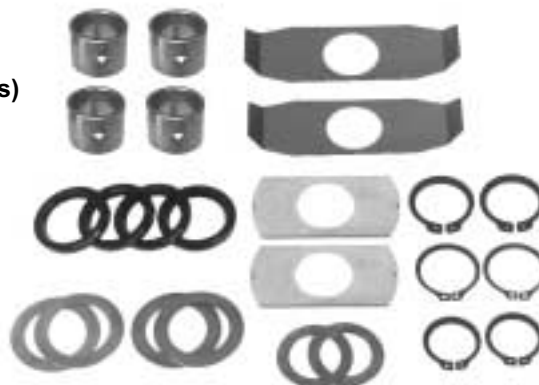

M
A
C
K

MACK

16-1/2" "Q" SPECIAL CLEARANCE FRONT BRAKE, ROCKWELL DESIGN

TIP Mack predominately, but also found on some other models; i.e.: Paccar, Volvo White.

Also see Eaton's "High Mount."

TIP L3126 spring mounting for use with "Q Plus" Cams or "claw"

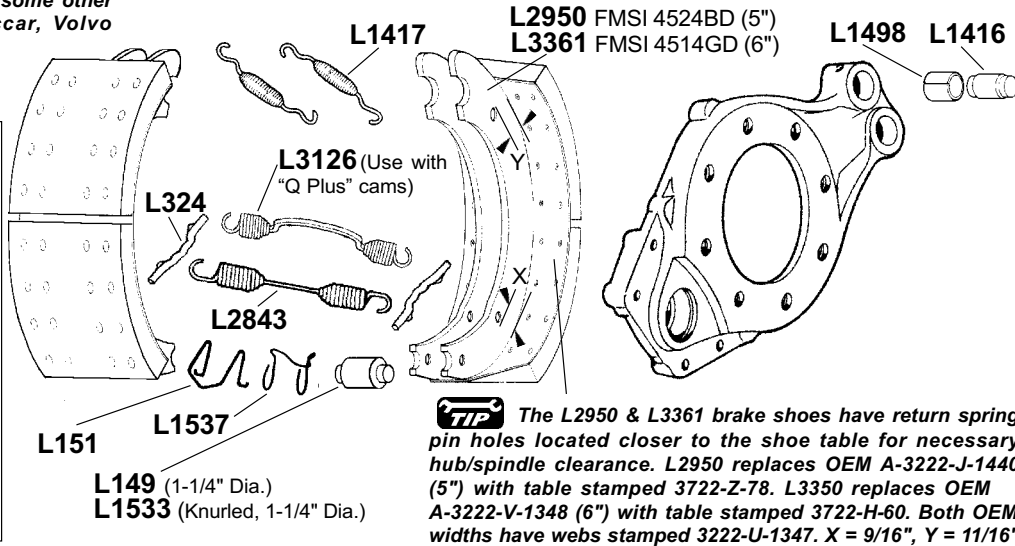
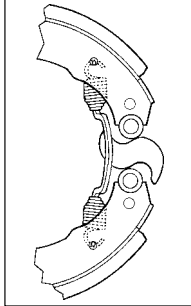

TIP The L2950 & L3361 brake shoes have return spring pin holes located closer to the shoe table for necessary hub/spindle clearance. L2950 replaces OEM A-3222-J-1440 (5") with table stamped 3722-Z-78. L3350 replaces OEM A-3222-V-1348 (6") with table stamped 3722-H-60. Both OEM widths have webs stamped 3222-U-1347. X = 9/16", Y = 11/16"

FOR OTHER MACK STEER AXLE BRAKE APPLICATIONS SEE EATON, ROCKWELL AND WAGNER SCHEMATIC SECTIONS.

TIP Do Not Confuse This Application With: OEM shoes with web stamping 3222-U-1529 (5") or 3222-H-1524 (6") which have both relocated return and retaining spring holes. X = 3/4", Y = 3/8"

Aftermarket shoes with two return spring pin holes on each web use the upper pin hole nearest to the shoe table to attach the return spring. The lower holes are used for standard FMSI 4524BD and 4514GD applications.

Brake Repair Kits:

Using L3126 for "Claw Head" or "Q-Plus" cams:
K334 (with L149)
K334K (with L1533)

Using L2843 for "Claw Head" cam only:
K292 (with L149)

Camshafts: "Claw Head" or "Q Plus" type

MACK 16-1/2" CAMSHAFT IDENTIFICATION

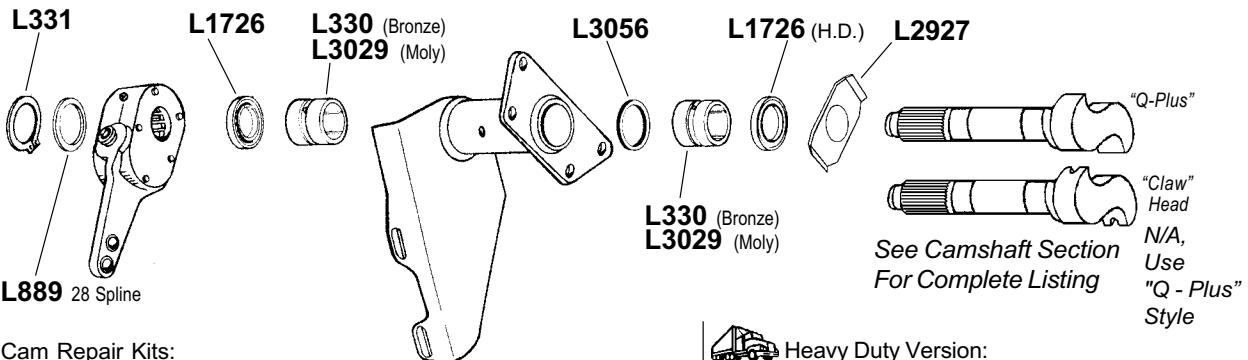
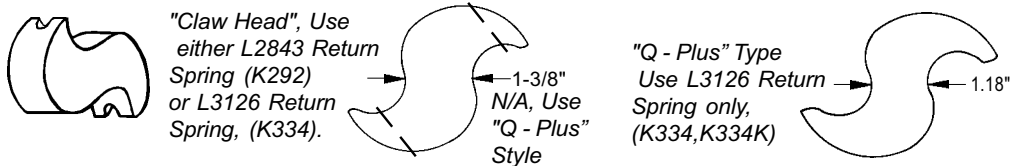

Cam Repair Kits:

K81 - Axle, with L3029 Molydisulfide bushings.
K48 - Wheel, with L3029 Molydisulfide bushings.



Heavy Duty Version:

K351 - Axle, with L330 Bronze bushings
K365 - Wheel, with L330 Bronze bushings

Schematic Diagram Charts
4

MACK

BRAKE REPAIR KITS

MACK

K292

For Mack (Rockwell)
16-1/2" x 5" "Q" Steering Axle

Contains:

2 Pcs. - L149	Roller
2 Pcs. - L151	Roller Retainer
2 Pcs. - L324	Return Spring Pin
2 Pcs. - L1416	Anchor Pin
2 Pcs. - L1417	Retainer Spring
2 Pcs. - L1498	Anchor Pin Bushing
1 Pc. - L2843	Brake Return Spring



Contains parts to service one wheel.

Schematic
Diagram
Charts

4

K334

For Mack (Rockwell) 16-1/2" x 5" or 6"
"Q" Steering Axle using "Q-Plus" Camshafts
and Special Clearance Return Spring

Contents:

2 Pcs. - L149	Roller
2 Pcs. - L151	Roller Retainer
2 Pcs. - L324	Return Spring Pin
2 Pcs. - L1416	Anchor Pin
2 Pcs. - L1417	Retainer Spring
2 Pcs. - L1498	Anchor Pin Bushing
1 Pc. - L3126	H.D. Return Spring



Contains parts to service one wheel

K334K

For Mack (Rockwell) 16-1/2" x 5" or 6"
"Q" Steering Axle using "Q-Plus" Camshafts
and Special Clearance Return Spring

Contents:

2 Pcs. - L151	Roller Retainer
2 Pcs. - L324	Return Spring Pin
2 Pcs. - L1416	Anchor Pin
2 Pcs. - L1417	Retainer Spring
2 Pcs. - L1498	Anchor Pin Bushing
2 Pcs. - L1533	Knurled Roller
1 Pc. - L3126	H.D. Return Spring



Contains parts to service one wheel

M
A
C
K

CAM REPAIR KITS

MACK

K81

Axle Cam Kit For Mack (Rockwell) "P" or "Q" Drive or Steer Axle 1-1/2"-10 or 28 Spline Cams

Contains:

- 2 Pcs. - L137 Lock Ring
- 2 Pcs. - L192 Spacer Washer
- 2 Pcs. - L193 Spacer Washer
- 4 Pcs. - L329 Neoprene Seal
- 2 Pcs. - L331 Lock Ring
- 2 Pcs. - L889 Spacer Washer
- 2 Pcs. - L2900 Snap Ring
- 2 Pcs. - L2926 Washer
- 2 Pcs. - L2927 Washer
- 4 Pcs. - L3029 Bushing



Contains parts to service one axle.

For one wheel end kit, use **K48**.

K351

Axle Kit For Mack (Rockwell) Heavy Duty "Q" Drive Axle (Also For other Rockwell Drive and Steer Applications)

Contents:

- 2 Pcs. - L137 Lock Ring
- 2 Pcs. - L192 Spacer Washer
- 2 Pcs. - L193 Spacer Washer
- 4 Pcs. - L329 Cam Seal
- 4 Pcs. - L330 Bronze Bushing
- 2 Pcs. - L331 H.D. Lock Ring
- 2 Pcs. - L889 Spline Washer
- 2 Pcs. - L2900 H.D. Lock Ring
- 2 Pcs. - L2926 Cam Head Washer
- 2 Pcs. - L2927 Cam Head Washer

Use **K365** to service One Wheel End

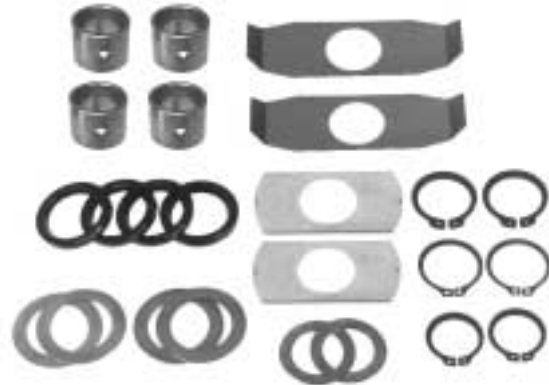

Heavy Duty Version

Schematic
Diagram
Charts

4

**M
A
C
K**

MACK

16-1/2" x 7" HEAVY DUTY "Q" DRIVE AXLE BRAKE - ROCKWELL DESIGN

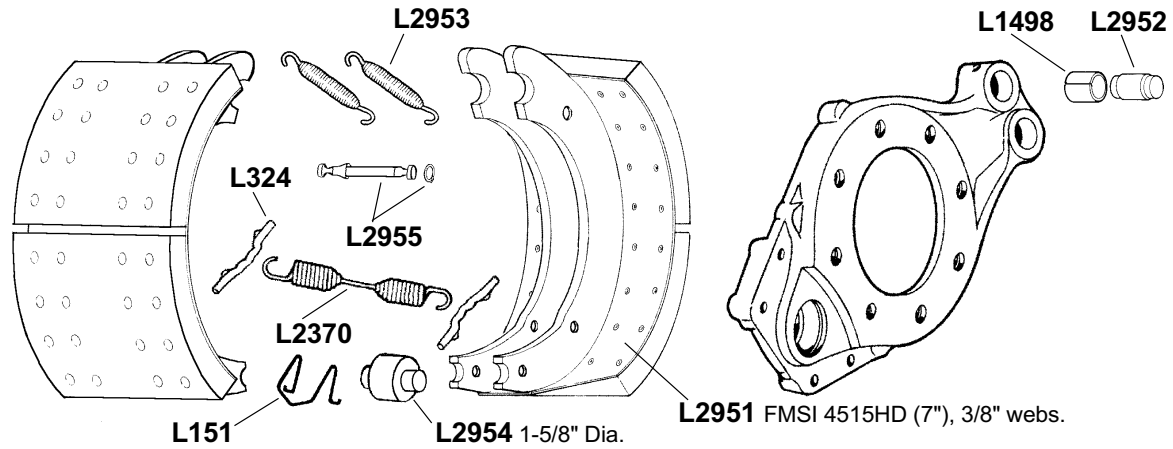

Schematic
Diagram
Charts
4

Brake Repair Kits:



Heavy Duty Versions:

K293M Includes L2955 retainer spring pin assembly.

K293 Without L2955 retainer spring pin assembly.

Camshafts: Standard S or "Q- Plus" type



The L2951 brake shoe has thicker 3/8" webs and uses the L2955 retainer spring pin at the anchor end to attach the L2953 retainer springs. Substitution of L1478 Standard "Q" shoes and hardware is not recommended.

MACK 16-1/2" CAMSHAFT IDENTIFICATION

Standard S-head,
16-1/2" Brakes
1-1/2" - 10 and
28 Spline

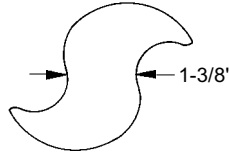

"Q - Plus" Type
Must be used as
LH/RH pair on
an axle

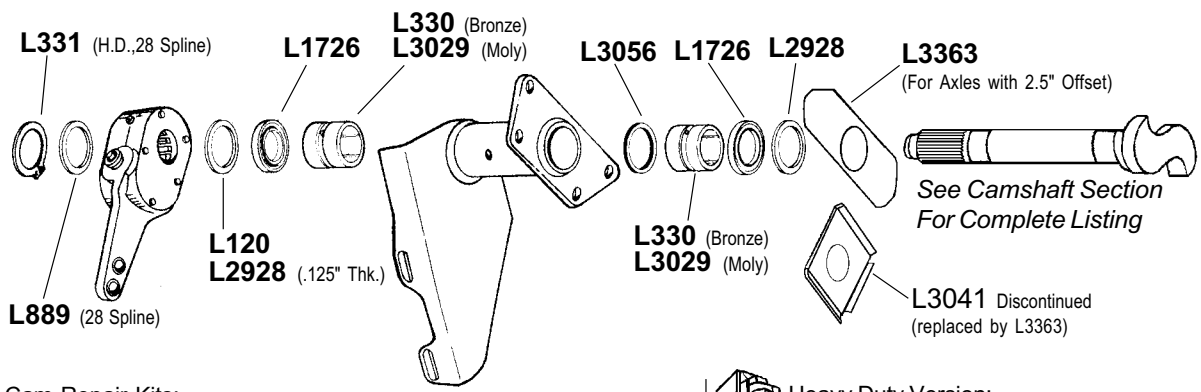
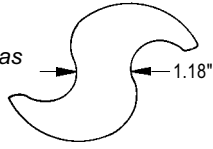

Cam Repair Kits:

K310 - Wheel, with L3029 Molydisulfide bushings & L3363 washer



Heavy Duty Version:

K351 - Axle, with L330 Bronze bushings *

K365 - Wheel, with L330 Bronze bushings *

* May require the addition of L3363 cam head washer(s).

MACK

BRAKE REPAIR KITS

MACK

K293

For Mack (Rockwell)

16-1/2" x 7" Heavy Duty "Q" Drive Axle

Contains:

- | | |
|----------------|--------------------|
| 2 Pcs. - L151 | Roller Retainer |
| 2 Pcs. - L324 | Return Spring Pin |
| 2 Pcs. - L1498 | Anchor Pin Bushing |
| 1 Pc. - L2370 | HD Return Spring |
| 2 Pcs. - L2952 | Anchor Pin |
| 2 Pcs. - L2953 | Retainer Spring |
| 2 Pcs. - L2954 | Roller |

Contains parts to service one wheel.



Schematic
Diagram
Charts

4

K293M

For Mack (Rockwell)

16-1/2" x 7" Heavy Duty "Q" Drive Axle

Contains:

- | | |
|----------------|--------------------|
| 2 Pcs. - L151 | Roller Retainer |
| 2 Pcs. - L324 | Return Spring Pin |
| 2 Pcs. - L1498 | Anchor Pin Bushing |
| 1 Pc. - L2370 | HD Return Spring |
| 2 Pcs. - L2952 | Anchor Pin |
| 2 Pcs. - L2953 | Retainer Spring |
| 2 Pcs. - L2954 | Roller |

Contains parts to service one wheel.



CAM REPAIR KITS

K310

For Mack Heavy Duty "Q" Drive Axle

Contains:

- | | |
|----------------|-----------------|
| 1 Pc. - L331 | H.D. Lock Ring |
| 2 Pcs. - L889 | Washer |
| 2 Pcs. - L1726 | Seal |
| 1 Pc. - L2928 | Washer |
| 2 Pcs. - L3029 | Bushing |
| 1 Pc. - L3363 | Cam Head Washer |

Contains parts to service one wheel.



K351

Axle Kit For Mack (Rockwell)
Heavy Duty "Q" Drive Axle

(And other Rockwell Drive and Steer Applications)

Contents:

- | | |
|----------------|-----------------|
| 2 Pcs. - L137 | Lock Ring |
| 2 Pcs. - L192 | Spacer Washer |
| 2 Pcs. - L193 | Spacer Washer |
| 4 Pcs. - L329 | Cam Seal |
| 4 Pcs. - L330 | Bronze Bushing |
| 2 Pcs. - L331 | H.D. Lock Ring |
| 2 Pcs. - L889 | Spline Washer |
| 2 Pcs. - L2900 | H.D. Lock Ring |
| 2 Pcs. - L2926 | Cam Head Washer |
| 2 Pcs. - L2927 | Cam Head Washer |

Use **K365** to service One Wheel End

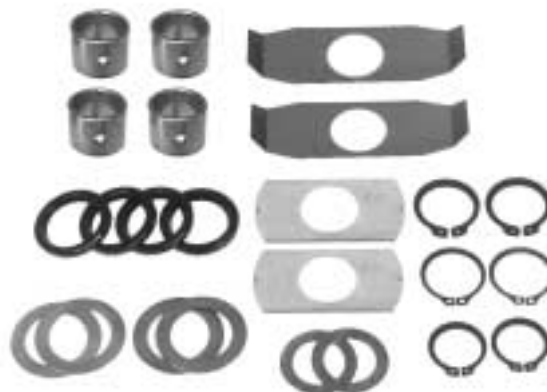

M
A
C
K

 Heavy Duty Version

MACK

16-1/2" x 7" HEAVY DUTY "Q PLUS" DRIVE AXLE BRAKE - ROCKWELL DESIGN

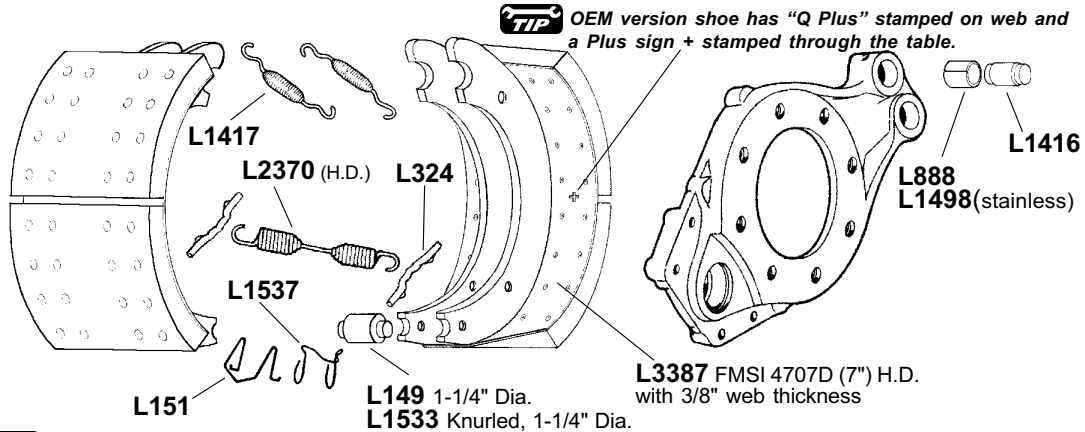

Schematic
Diagram
Charts
4

TIP The L2370 H.D. return spring contained in all kits is manufactured from SAE Music Wire, shot peened for added strength, cycle life and resistance to extreme temperature ranges. A high amount of spring force advertised by suppliers is not a total factor in determining spring quality and often can be the opposite. The L2370 is used and recommended for this application due to increased shoe weight and brake applications from the FMSI 4707D extended wear blocks.

Brake Repair Kits:

Heavy Duty Major Versions:

- K128 - Recommended
- K128K
- K329
- K332



Heavy Duty Minor Versions:

- K128A
- K304
- K304K
- K320
- K370

Camshafts: 1-1/2"-28 spline "Q Plus" S-head profile types.

16-1/2" "Q - PLUS" TYPE CAMSHAFT IDENTIFICATION

"Q - Plus" Type, Aftermarket version may have slightly lesser distance across "S" pocket. This will not affect performance when used opposite an OEM version.

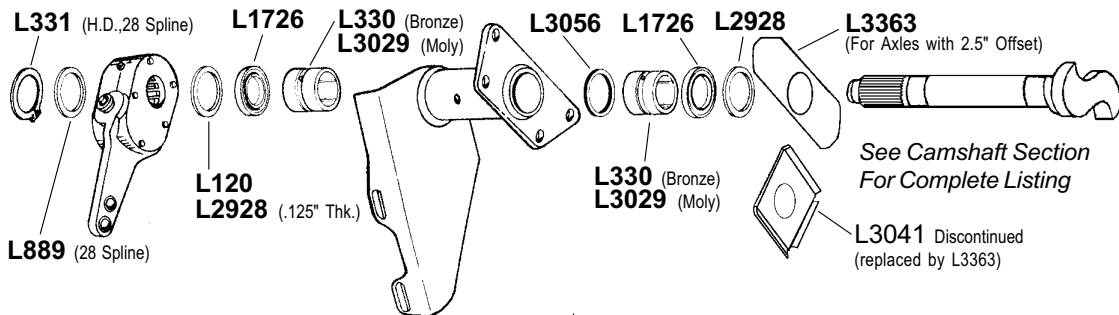
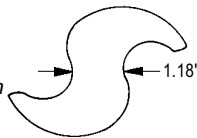

See Camshaft Section
For Complete Listing

Cam Repair Kits with L3029 Molydisulfide bushings:

- K48 - Wheel End
- K81 - Axle
- K310 - Wheel, w/ L3363



Heavy Duty Versions with L330 Bronze bushings

- K351 - Axle
- K365 - Wheel End



H. D. Version

MACK

BRAKE REPAIR KITS

MACK

HEAVY DUTY - MAJOR REPAIR KITS

K128

Major Repair Kit For Mack (Rockwell) 16-1/2" Heavy Duty "Q Plus" Drive Axle Brake

- Contains:
- 2 Pcs. - L149 Roller
 - 2 Pcs. - L324 Return Spring Pin
 - 2 Pcs. - L1416 Anchor Pin
 - 2 Pcs. - L1417 Retainer Spring
 - 2 Pcs. - L1498 Anchor Pin Bushing
 - 2 Pcs. - L1537 Roller Retainer
 - 1 Pcs. - L2370 HD Return Spring

Contains parts to service one wheel.



K128K

Major Repair Kit For Mack (Rockwell) 16-1/2" Heavy Duty "Q Plus" Drive Axle Brake

- Contains:
- 2 Pcs. - L324 Return Spring Pin
 - 2 Pcs. - L1416 Anchor Pin
 - 2 Pcs. - L1417 Shoe Retainer Spring
 - 2 Pcs. - L1498 Anchor Pin Spider Bushing
 - 2 Pcs. - L1533 Knurled Roller
 - 2 Pcs. - L1537 Roller Retainer
 - 1 Pc. - L2370 Shoe Return Spring

Contains parts to service one wheel.
Same as K128 except L149 roller is replaced by L1533 knurled roller.



K329

Major Repair Kit For Mack (Rockwell) 16-1/2" Heavy Duty "Q Plus" Drive Axle Brake

- Contains:
- 2 Pcs. - L151 Roller Retainer
 - 2 Pcs. - L324 Return Spring Pin
 - 2 Pcs. - L888 Anchor Pin Spider Bushing
 - 2 Pcs. - L1416 Anchor Pin
 - 2 Pcs. - L1417 Shoe Retainer Spring
 - 2 Pcs. - L1533 Knurled Roller
 - 1 Pc. - L2370 Shoe Return Spring

Contains parts to service one wheel.
Same as K128K except L1537 is replaced by L151 and L1498 is replaced by L888.



K332

Major Repair Kit For Mack (Rockwell) 16-1/2" Heavy Duty "Q Plus" Drive Axle Brake

- Contains:
- 2 Pcs. - L149 Roller
 - 2 Pcs. - L151 Roller Retainer
 - 2 Pcs. - L324 Return Spring Pin
 - 2 Pcs. - L888 Anchor Pin Spider Bushing
 - 2 Pcs. - L1416 Anchor Pin
 - 2 Pcs. - L1417 Shoe Retainer Spring
 - 1 Pc. - L2370 Shoe Return Spring

Contains parts to service one wheel.
Same as K128 except L1537 is replaced by L151 and L1498 is replaced by L888.



Schematic
Diagram
Charts

4

M
A
C
K

 H. D. Version

BRAKE REPAIR KITS

MACK

HEAVY DUTY - MINOR REPAIR KITS

K128A

Minor Repair Kit For Rockwell 16-1/2" "Q Plus" Self Contained Drive Axle Brake

Contains:

- 2 Pcs. - L149 Roller
- 2 Pcs. - L324 Return Spring Pin
- 2 Pcs. - L1416 Anchor Pin
- 2 Pcs. - L1417 Shoe Retainer Spring
- 2 Pcs. - L1537 Roller Retainer
- 1 Pc. - L2370 HD Return Spring

Contains parts to service one wheel.
Same as K128 except does not contain L1498 anchor pin bushings.



Schematic
Diagram
Charts

4

K304

Minor Repair Kit For Rockwell 16-1/2" "Q Plus" Self Contained Drive Axle Brake

Contains:

- 2 Pcs. - L149 Roller
- 2 Pcs. - L324 Return Spring Pin
- 2 Pcs. - L1417 Retainer Spring
- 2 Pcs. - L1537 Roller Retainer
- 1 Pc. - L2370 H.D. Return Spring

Contains parts to service one wheel.
Same as K128 except does not contain
L1416 anchor pins and L1498 anchor pin bushings.



K304K

Minor Repair Kit "ES" "Extended Service" For Rockwell and other 16-1/2" Std. "Q" Brakes

Kit Contains:

- 2 Pcs. - L1533 Knurled Roller
- 2 Pcs. - L324 Return Spring Pin
- 2 Pcs. - L1417 Retainer Spring
- 2 Pcs. - L1533 Knurled Roller
- 2 Pcs. - L1537 Roller Retainer
- 1 Pc. - L2370 H.D. Return Spring

Contains parts to service one wheel.
Same as K304 except L149 roller is replaced by
L1533 knurled roller.

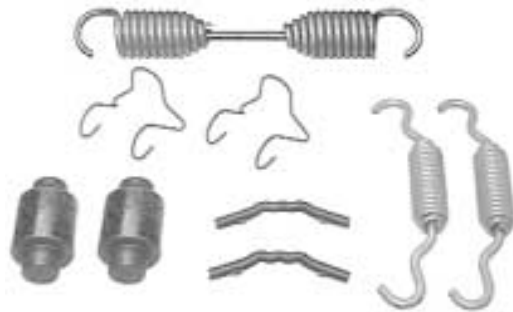

K320

Minor Repair Kit For Rockwell 16-1/2" "Q Plus" Self Contained Drive Axle Brake

Contains:

- 2 Pcs. - L1417 Retainer Spring
- 1 Pc. - L2370 H.D. Return Spring

Contains parts to service one wheel.



 H. D. Version

© Copyright 2003 Triangle Suspension Systems, Inc.

BRAKE REPAIR KITS

MACK

HEAVY DUTY - MINOR REPAIR KITS

K370

Minor Kit For 16-1/2" "FC" Brakes Using Heavy Duty Return Spring

Contains:

- 2 Pcs. - L149 Roller
- 2 Pcs. - L1417 Retainer Springs
- 1 Pc. - L2370 H.D. Return Spring

Contains parts to service one wheel.



CAM REPAIR KITS

K81

Axle Cam Kit For Mack (Rockwell) "P" or "Q" Drive or Steer Axle 1-1/2"-10 or 28 Spline Cams

Contains:

- 2 Pcs. - L137 Lock Ring
- 2 Pcs. - L192 Spacer Washer
- 2 Pcs. - L193 Spacer Washer
- 4 Pcs. - L329 Neoprene Seal
- 2 Pcs. - L331 Lock Ring
- 2 Pcs. - L889 Spacer Washer
- 2 Pcs. - L2900 Snap Ring
- 2 Pcs. - L2926 Washer
- 2 Pcs. - L2927 Washer
- 4 Pcs. - L3029 Bushing

Contains parts to service one axle.

For one wheel end kit, use **K48**.



K310

For Mack Heavy Duty "Q" Drive Axle

Contains:

- 1 Pc. - L331 H.D. Lock Ring
- 2 Pcs. - L889 Washer
- 2 Pcs. - L1726 Seal
- 1 Pc. - L2928 Washer
- 2 Pcs. - L3029 Bushing
- 1 Pc. - L3363 Cam Head Washer

Contains parts to service one wheel.



K351

Axle Kit For Mack (Rockwell) Heavy Duty "Q" Drive Axle (And other Rockwell Drive and Steer Applications)

Contents:

- 2 Pcs. - L137 Lock Ring
- 2 Pcs. - L192 Spacer Washer
- 2 Pcs. - L193 Spacer Washer
- 4 Pcs. - L329 Cam Seal
- 4 Pcs. - L330 Bronze Bushing
- 2 Pcs. - L331 H.D. Lock Ring
- 2 Pcs. - L889 Spline Washer
- 2 Pcs. - L2900 H.D. Lock Ring
- 2 Pcs. - L2926 Cam Head Washer
- 2 Pcs. - L2927 Cam Head Washer

Use **K365** to service One Wheel End

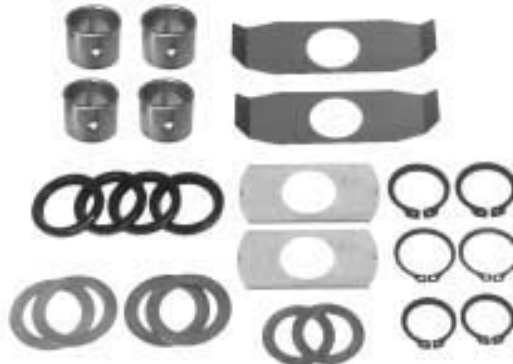

Schematic
Diagram
Charts

4

M
A
C
K



LELAND REPLACEMENT PARTS FOR
MACK
 16-1/2" x 7" MACK "P" TYPE
 SELF CONTAINED TRACTOR BRAKE

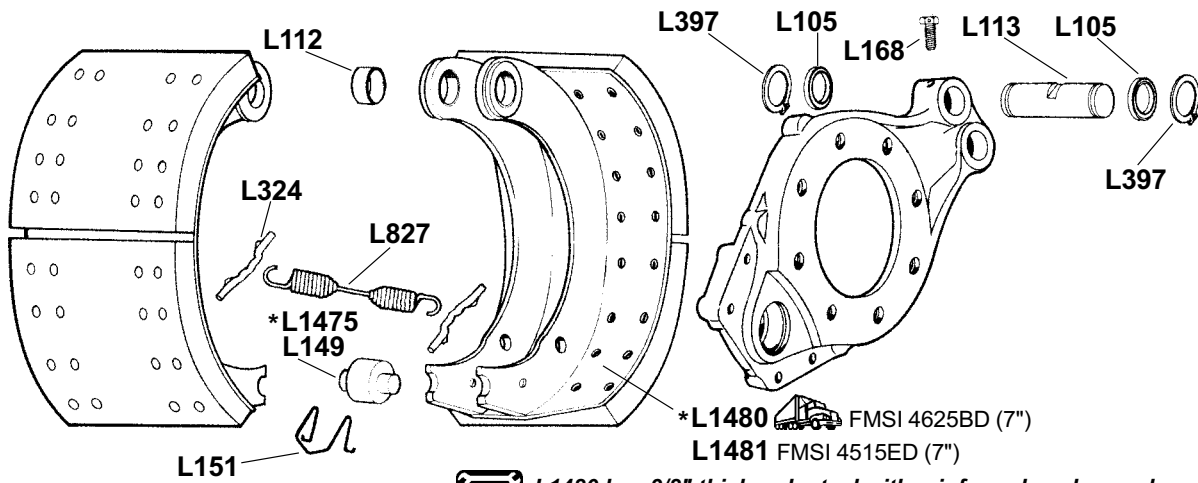

Schematic
 Diagram
 Charts
4

Brake Repair Kits:



Heavy Duty Version:

- K77** Used with L1480 Brake Shoe
- K46** Used with L1481 Brake Shoe



L1480 has 3/8" thick web steel with reinforced anchor ends.
L1481 has standard 3/16" thick web steel with reinforced anchor ends.

MACK 16-1/2" CAMSHAFT IDENTIFICATION

Standard S-head,
 16-1/2" Brakes
 1-1/2" - 10 and
 28 Spline

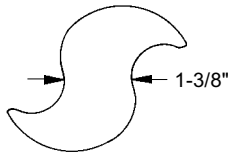

"Q - Plus" Type
 Must be used as
 LH/RH pair on
 an axle

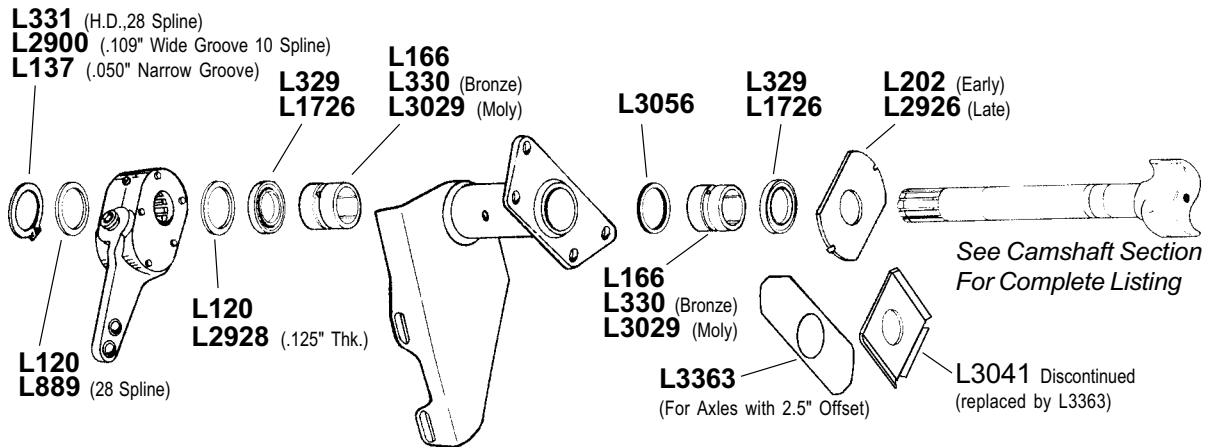
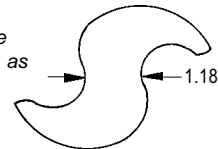

See Camshaft Section
 For Complete Listing

Cam Repair Kits:

- K81** - Axle, with L166 Nylon bushings
- K48** - Wheel, with L166 Nylon bushings
- K310** - Wheel, with L3029 Molydisulfide bushings & L3363 washer



Heavy Duty Versions:

- K351** - Axle, with L330 Bronze bushings *
 - K365** - Wheel, with L330 Bronze bushings *
- * May require the addition of L3363 cam head washer(s).

**M
 A
 C
 K**

BRAKE REPAIR KITS

MACK

K77

For Mack 16 1/2" Drive Axles
using 4625BD Lining

Contains:

- 4 Pcs. - L105 Anchor Pin Seal
- 4 Pcs. - L111 Anchor Pin Lock
- 2 Pcs. - L113 Anchor Pin
- 2 Pcs. - L151 Roller Retainer
- 2 Pcs. - L168 Anchor Pin Lock Screw
- 2 Pcs. - L324 Return Spring Pin
- 4 Pcs. - L397 Anchor Pin Lock Ring
- 1 Pc. - L827 Shoe Return Spring
- 2 Pcs. - L1475 Roller



Contains parts to service one wheel.
For Mack applications with 4515ED, use K46.

Schematic
Diagram
Charts

4

K46

For Mack 16 1/2" Bushed Shoe
using 4515ED Lining

Contains:

- 4 Pcs. - L105 Neoprene Seal
- 4 Pcs. - L111 Anchor Pin Lock
- 2 Pcs. - L113 Anchor Pin
- 2 Pcs. - L149 Roller
- 2 Pcs. - L151 Roller Retainer
- 2 Pcs. - L168 Anchor Pin Lock Screw
- 2 Pcs. - L324 Return Spring Pin
- 4 Pcs. - L397 Lock Ring
- 1 Pc. - L827 Return Spring



Contains parts to service one wheel.

M
A
C
K

CAM REPAIR KITS

MACK

K310

For Mack (Rockwell) Self Contained Brakes

Contains:

- | | |
|----------------|-----------------|
| 1 Pc. - L331 | H.D. Lock Ring |
| 2 Pcs. - L889 | Washer |
| 2 Pcs. - L1726 | Seal |
| 1 Pc. - L2928 | Washer |
| 2 Pcs. - L3029 | Bushing |
| 1 Pc. - L3363 | Cam Head Washer |



Contains parts to service one wheel.

Schematic
Diagram
Charts

4

K81

Axle Cam Kit For Mack (Rockwell) "P" or "Q" Drive or Steer Axle 1-1/2"-10 or 28 Spline Cams

Contains:

- | | |
|----------------|---------------|
| 2 Pcs. - L137 | Lock Ring |
| 2 Pcs. - L192 | Spacer Washer |
| 2 Pcs. - L193 | Spacer Washer |
| 4 Pcs. - L329 | Neoprene Seal |
| 2 Pcs. - L331 | Lock Ring |
| 2 Pcs. - L889 | Spacer Washer |
| 2 Pcs. - L2900 | Snap Ring |
| 2 Pcs. - L2926 | Washer |
| 2 Pcs. - L2927 | Washer |
| 4 Pcs. - L3029 | Bushing |



Contains parts to service one axle.
For one wheel end kit, use **K48**.

M
A
C
K

K351

Axle Kit For Mack (Rockwell) Self Contained Brakes 10 or 28 Spline Cams

Contents:

- | | |
|----------------|-----------------|
| 2 Pcs. - L137 | Lock Ring |
| 2 Pcs. - L192 | Spacer Washer |
| 2 Pcs. - L193 | Spacer Washer |
| 4 Pcs. - L329 | Cam Seal |
| 4 Pcs. - L330 | Bronze Bushing |
| 2 Pcs. - L331 | H.D. Lock Ring |
| 2 Pcs. - L889 | Spline Washer |
| 2 Pcs. - L2900 | H.D. Lock Ring |
| 2 Pcs. - L2926 | Spacer Washer |
| 2 Pcs. - L2927 | Cam Head Washer |

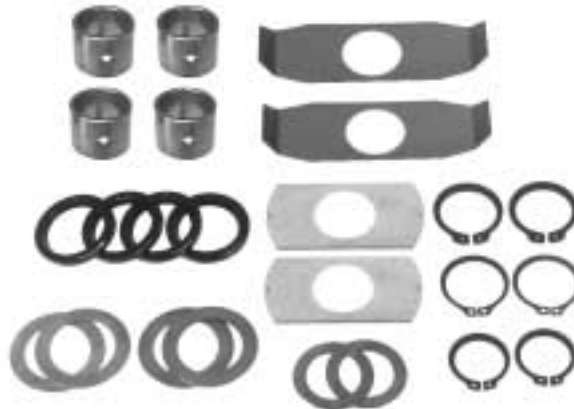

Use **K365** to service One Wheel End

