

DANA

PRESSED STEEL 12-1/4" BRAKE EARLY DESIGN FT TYPE BRAKES

Schematic
Diagram
Charts
4

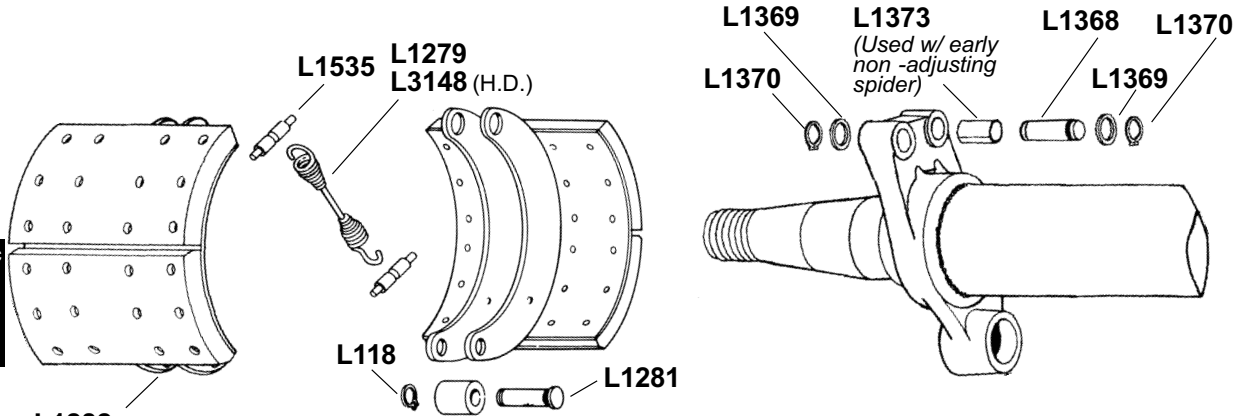

L1282 FMSI 4536BD (5-1/2")

L1283 FMSI 4591D (7-1/2")

TIP Do not use on
Dexter axles.

L1280 1-1/2" Dia.

L12901 1-1/4" Dia., optional for additional drum clearance.

TIP Do not use with "0794" "Fast Rise" camshafts.

L2943 1-5/8" Dia., 1/8" oversize.

Brake Repair Kit: **K69**

Heavy Duty Brake Repair Kit: **K352**

Camshafts: Standard S-head. **TIP** "Fast Rise" versions can be used in pairs of the same S-head profile per axle, (LH & RH), with appropriate size cam rollers. See page 24 for additional information.

**D
A
N
A**

EARLY DESIGN FC, "U-BRAKE"

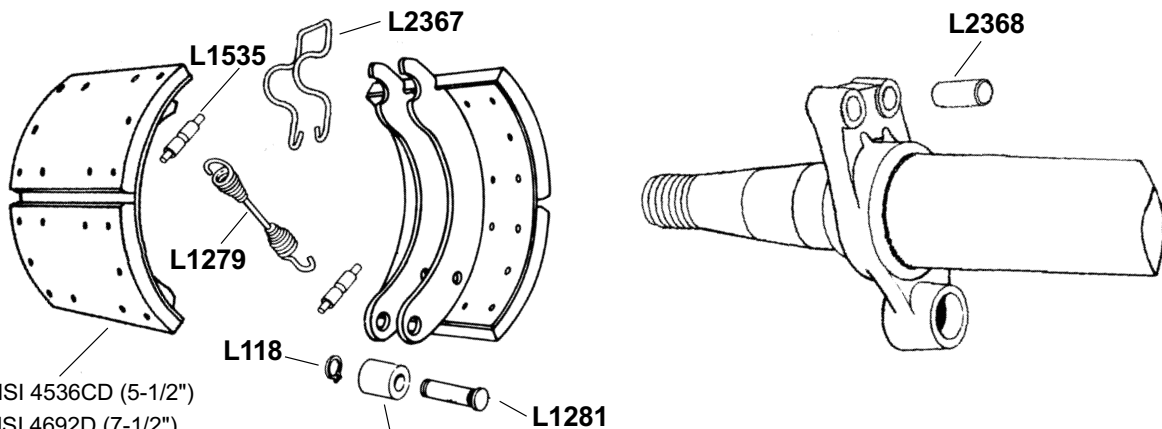

FMSI 4536CD (5-1/2")

FMSI 4692D (7-1/2")

Shoes no longer available.

TIP FC & FT versions can
be used 4 per axle with the
proper brake hardware kits
& camshafts.

L1280 1-1/2" Dia.

L12901 1-1/4" Dia., optional for additional drum clearance.

TIP Do not use with "0794" "Fast Rise" camshafts.

L2943 1-5/8" Dia., 1/8" oversize.

Brake Repair Kit: **K137**

Camshafts: Standard S-head.

TIP "Fast Rise" versions can be used in pairs of the same S-head profile per axle, (LH & RH), with appropriate size cam rollers. See page 24 for additional information.

DANA

PRESSED STEEL 12-1/4" BRAKE

2ND DESIGN FT TYPE SHOES USING "FAST RISE" CAMSHAFTS

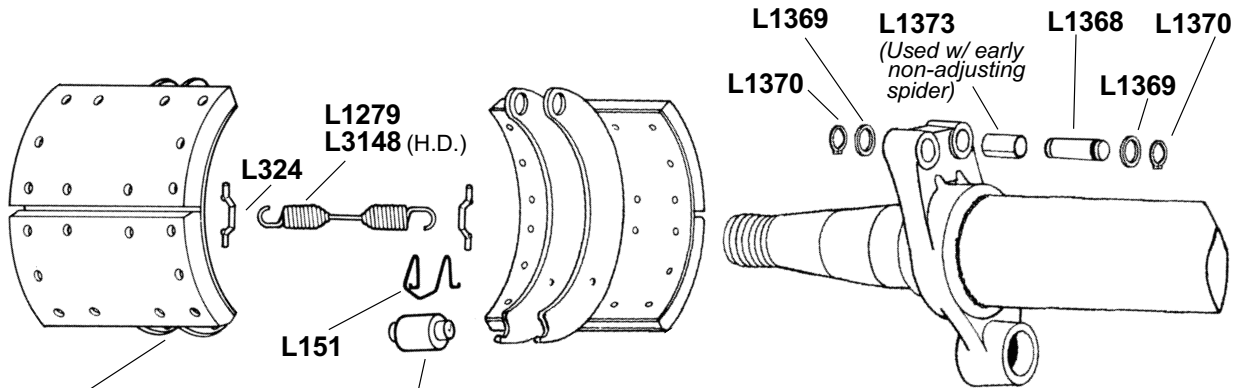

Schematic
Diagram
Charts
4

L2916 FMSI 4536ED (5-1/2")

L2917 FMSI 4692D (7-1/2")

TIP Do not use on Dexter axles. Do not substitute FMSI 4536BD for 4536ED.

L149 1-1/4" Dia. for 1st generation, (pre "0794") "Fast Rise" camshafts.

L158 1-1/2" Dia. for 2nd generation, ("0794") "Fast Rise" camshafts.

Brake Repair Kits: **K277**, for 1st generation "Fast Rise" cams.

K335, for 2nd generation, ("0794"), "Fast Rise" cams.

Camshafts: See camshaft S-head identification & information chart. See page 24 for additional information.

TIP 1st generation "Fast Rise" cams superseded by "0794" versions.

PRE 11/96 FC TYPE SHOES USING "FAST RISE" CAMSHAFTS

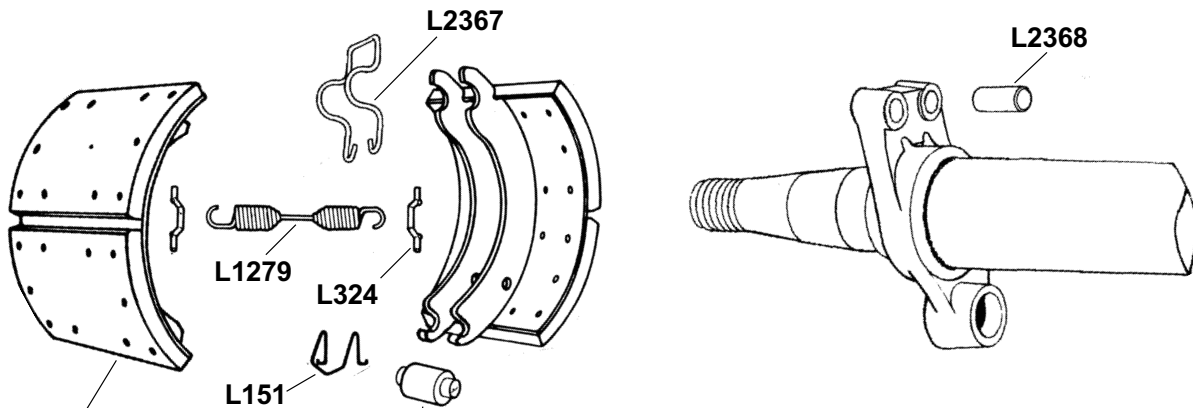

L3048 FMSI 4536ED (5-1/2")

L2918 FMSI 4692D (7-1/2")

TIP Do not use on Dexter axles. Do not substitute FMSI 4536BD for 4536ED.

L149 1-1/4" Dia. for 1st generation, (pre "0794") "Fast Rise" camshafts.

L158 1-1/2" Dia. for 2nd generation, ("0794") "Fast Rise" camshafts.

Brake Repair Kits: **K279**, for 1st generation "Fast Rise" cams.

K336, for 2nd generation, ("0794"), "Fast Rise" cams.

Camshafts: See camshaft S-head identification & information chart. See page 24 for additional information.

TIP 1st generation "Fast Rise" cams superseded by "0794" versions.

**D
A
N
A**

DANA

PRESSED STEEL 12-1/4" BRAKE

NEW STYLE FCII FOR POST 11/1/96 &
RETROFIT OF EARLIER TYPES

Schematic
Diagram
Charts

4

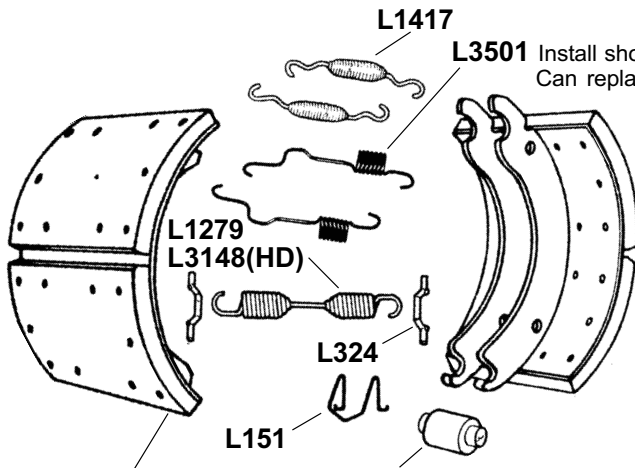

- L3395 FMSI 4661ED (5")
- L3048 FMSI 4536ED (5-1/2")
- L2918 FMSI 4692D (7-1/2")
- L158 1-1/2" Dia.

TIP Do not use on Dexter axles. Do not substitute FMSI 4536BD for 4536ED.

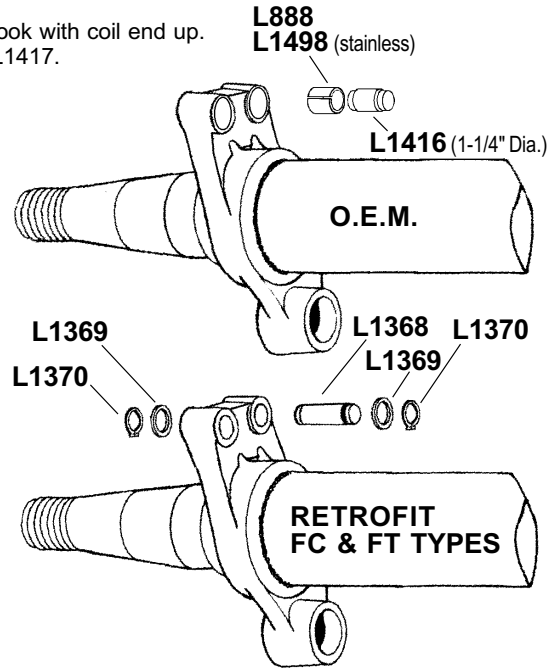

Brake Repair Kits: **K373**, O.E. style with L1417.
K501, O.E. style with L3501, for post 3/8/99 axles.
K377, For retrofit of earlier press steel versions, second generation "fast rise", "0794" type cams are required.
 Camshafts: 2nd generation, "0794", "fast rise" cams.

DANA

What is different from the previous FC style brake? The new style OEM FCII brake shoes have retaining spring holes in both webs replacing the notched web areas at the anchor end. The prior style anchor clamping spring and anchor pins (L2367 & L2368 type) are replaced by "Q" type components (L1416, L1417 and L1498). Dana brake spiders now have 1-3/8" diameter anchor pin bores to accommodate the larger diameter anchor pin and bushing. The L2918 (7-1/2") and L3048 (5-1/2") brake shoes now have web holes added for the L1417 and L3501 retaining springs in addition to the notched webs for L2367, allowing either attachment system. The L3395 (5") will be offered at this time with the new web hole configuration only, without the notched webs.

12-1/4" Dana FCII

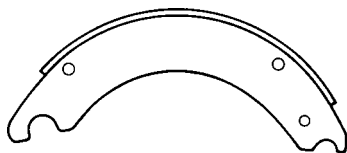

Current OEM Style FCII
L3395 (5")

12-1/4" Dana FC

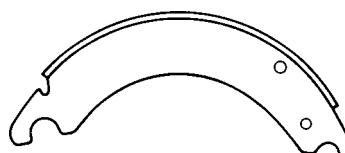

Early Version FC

Replaces FC & FCII Types

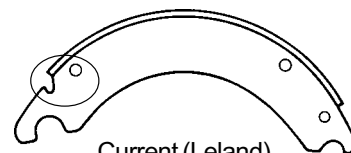

Current (Leland)
L2918 (7-1/2")
L3048 (5-1/2")

DANA

PRESSED STEEL 12-1/4" BRAKE

CAST SHOE CONVERSION TO EARLY DESIGN FT TYPE BRAKES OR SERVICE OF EARLY FT CONVERSION

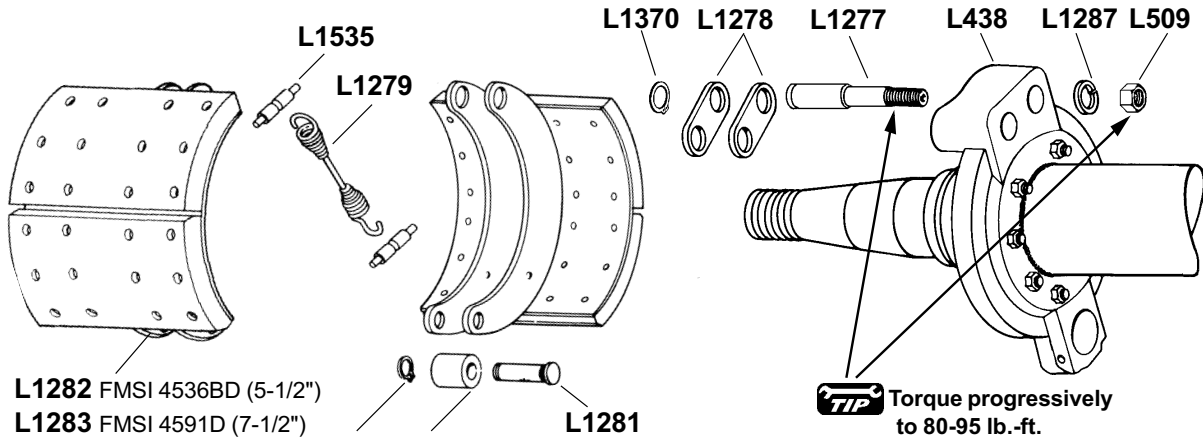

L1282 FMSI 4536BD (5-1/2")
L1283 FMSI 4591D (7-1/2")

L118 **L1280** 1-1/2" Dia.

L2901 1-1/4" Dia., optional for additional drum clearance.

TIP Do not use with "0794" "Fast Rise" camshafts.

L2943 1-5/8" Dia., 1/8" oversize.

TIP Torque progressively to 80-95 lb.-ft.

Brake Repair Kit: **K50**

Camshafts: *Standard S-head.*

TIP "Fast Rise" versions can be used in pairs of the same S-head profile per axle, (LH & RH), with appropriate size cam rollers. See page 24 for additional information.

Schematic
Diagram
Charts

4

CAST SHOE CONVERSION OF 2ND DESIGN FT TYPE BRAKES OR SERVICE OF EXISTING 2ND DESIGN FT CONVERSION

Can convert to late design FC with the addition of L2367.

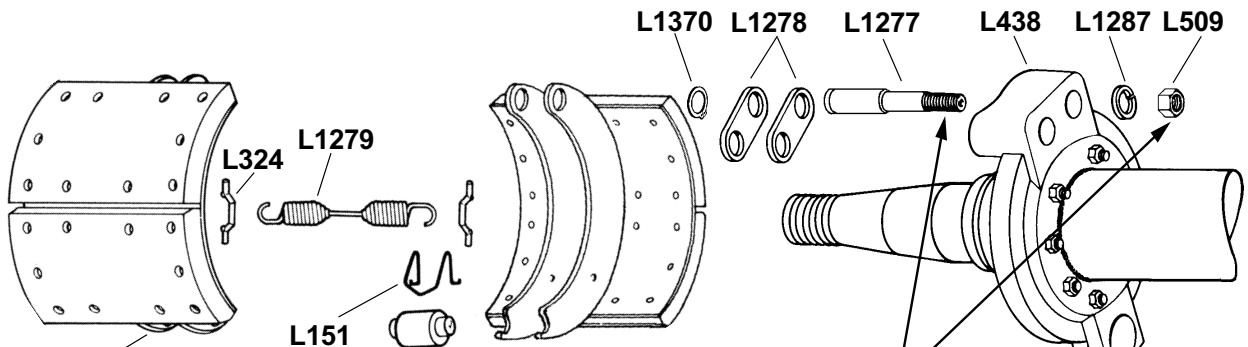

L2916 FMSI 4536ED (5-1/2")

L2917 FMSI 4692D (7-1/2")

TIP Do not substitute FMSI 4536BD for 4536ED.

L149 1-1/4" Dia. for 1st generation, (pre "0794") "Fast Rise" camshafts.

L158 1-1/2" Dia. for 2nd generation, ("0794") "Fast Rise" camshafts.

TIP Torque progressively to 80-95 lb.-ft.

Brake Repair Kits: **K288**, for 1st generation "Fast Rise" cams.

K338, for 2nd generation, ("0794"), "Fast Rise" cams.

Camshafts: See camshaft S-head identification & information chart. See page 24 for additional information.

TIP 1st generation "Fast Rise" cams superseded by "0794" versions.

D
A
N
A

DANA

CAST 12-1/4" BRAKE

12-1/4" BRAKE WITH CAST SHOES

Schematic
Diagram
Charts

4

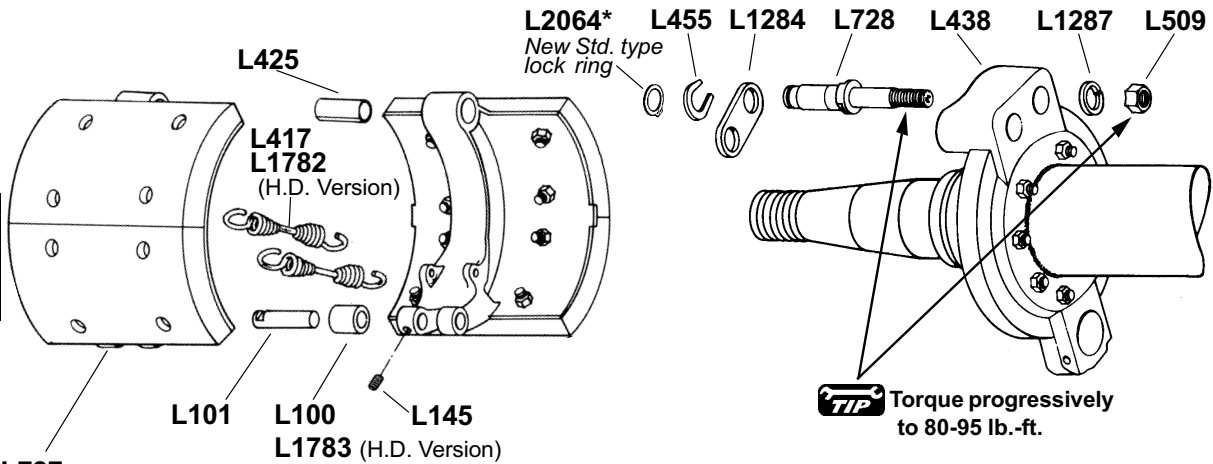

L727 FMSI 4544D (5-1/2")

L726 FMSI 4607D (7-1/2")

* L2064 available only in Brake Repair Kit K62.

Brake Repair Kit: **K62**

Camshafts: *Standard S-head only.*

12-1/4" BRAKE - CAMSHAFT IDENTIFICATION

IMPORTANT!



DO NOT MIX DIFFERENT CAM VERSIONS OR DIFFERENT SIZE CAM ROLLERS ON AN AXLE.

ALWAYS CHECK FOR HEAD STAMPING OR MEASURE HEAD TO CONFIRM TYPE.

DO NOT USE "FAST RISE" CAMSHAFTS WITH 12-1/4" CAST BRAKE SHOES.

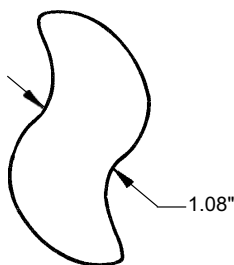

Standard
"Small S"

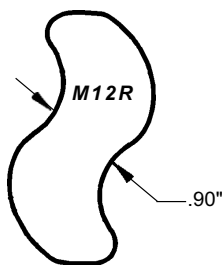

First generation "Fast Rise"
camshafts use the L149, 1-1/4" diameter
cam roller. The cam S heads are marked
M12L or M12R.
Note the 0.090" distance across the S
head. Discontinued, see "0794" version
notes.

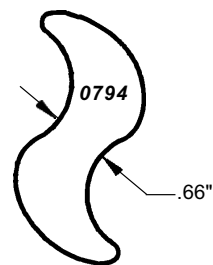

Second generation "Fast Rise"
"0794" (July 1994) camshafts use the
L158, 1-1/2" diameter cam roller. The cam
S heads are marked 0794L or 0794R.
Note the 0.66" distance across the S
head. These must be used in pairs, LH
and RH, on an axle. All retrofits from
standard or first generation "Fast Rise"
to the second generation "0794" must be
done in pairs, LH and RH, on an axle to
provide stable braking.

D
A
N
A

DANA

12-1/4" BRAKES - CAMSHAFT ASSEMBLY PARTS

1-1/2" CAM BEARING SURFACES WITH WELD ON SPIDER AND PRESSED STEEL SHOES

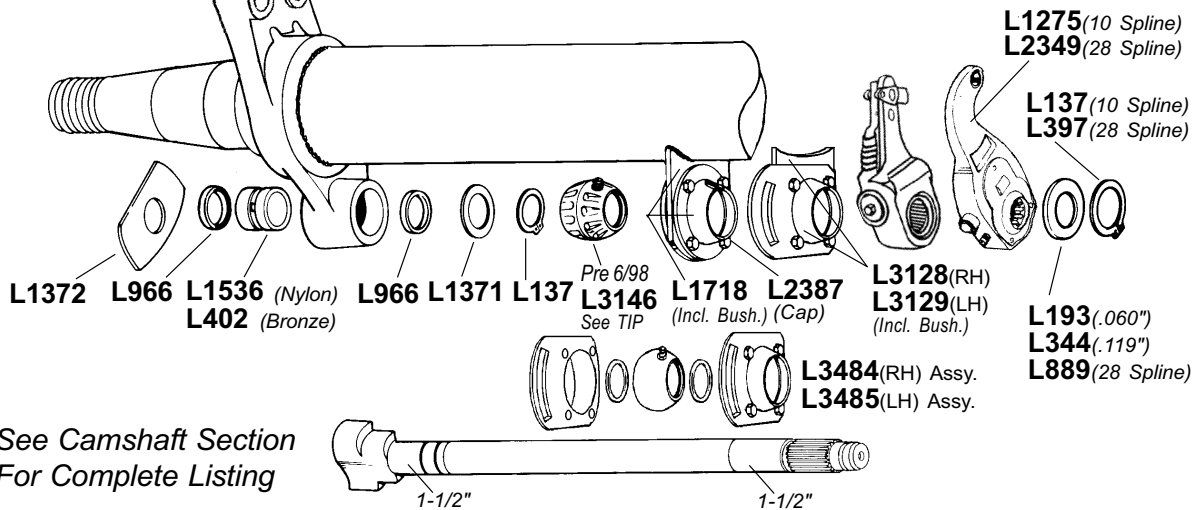

See Camshaft Section For Complete Listing

Cam Repair Kits using L1536 nylon spider bushing: **K345 Axle**
K145 Wheel
 Heavy Duty Cam Repair Kits using L402 bronze spider bushing: **K347 Axle**
K337 Wheel

TIP L3128/L3129 & L3484/L3485 can replace earlier style assemblies. Cam bracket bushings are not interchangeable between post 6/98 and earlier version assemblies.

Schematic Diagram Charts

4

1-5/8" & 1-1/2" CAM BEARING SURFACE DIAMETERS FROM MID-'95

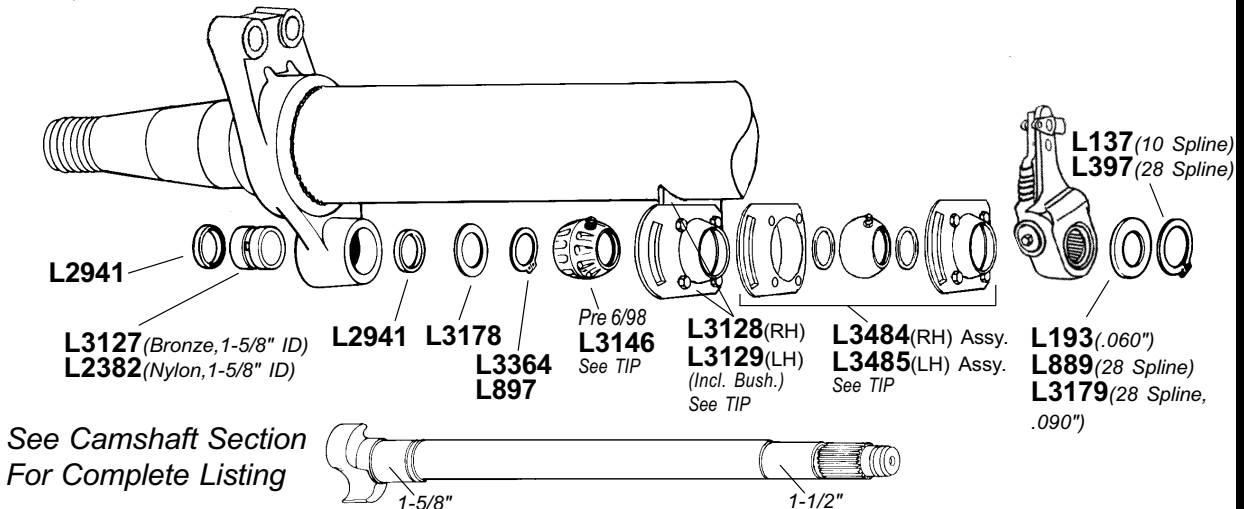

See Camshaft Section For Complete Listing

TIP L3128/L3129 & L3484/L3485 can replace earlier style assemblies. Cam bracket bushings are not interchangeable between post 6/98 and earlier version assemblies.

Heavy Duty Cam Repair Kits with L3127 bronze spider bushing:
Using L3146: **K505 Axle**
K355 Wheel
Using L3484 & L3485: **K494 Axle**
K482 RH (Curbside) Wheel
K483 LH (Roadside) Wheel

Cam Repair Kits with L2382 Nylatron spider bushing:
Using L3146: **K543 Axle**
K514 Wheel
Using L3484 & L3485: **K507 Axle**
K508 RH (Curbside) Wheel
K509 LH (Roadside) Wheel

D
A
N
A

DANA

12-1/4" BRAKES

12-1/4" CAST BRAKE TYPE AXLE WITH BOLT ON OR WELD ON SPIDER

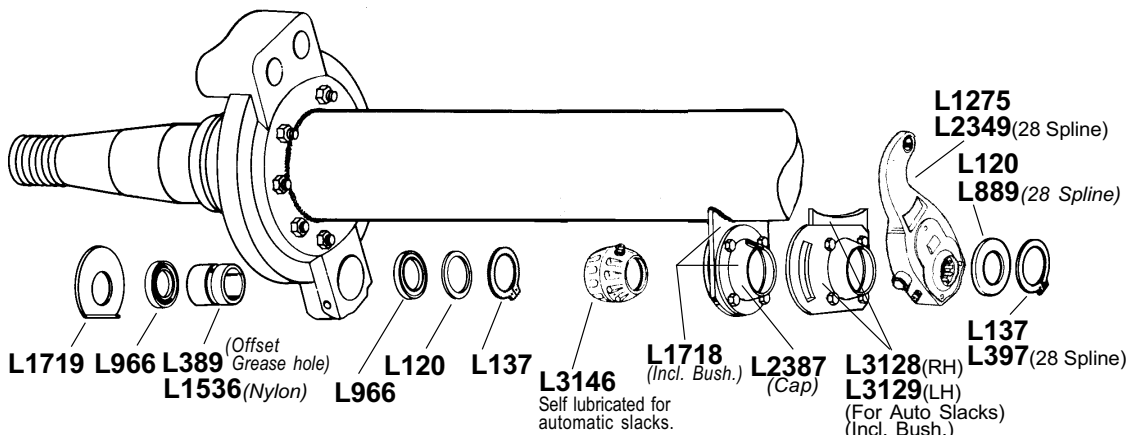

Schematic
Diagram
Charts

4

See Camshaft Section
For Complete Listing

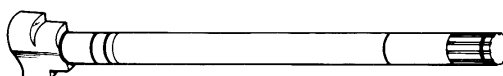

Cam Repair Kits: **K144** Rigid cam support bracket
K342 Spherical cam support bracket

WHEEL HUB & AXLE ASSEMBLY PARTS

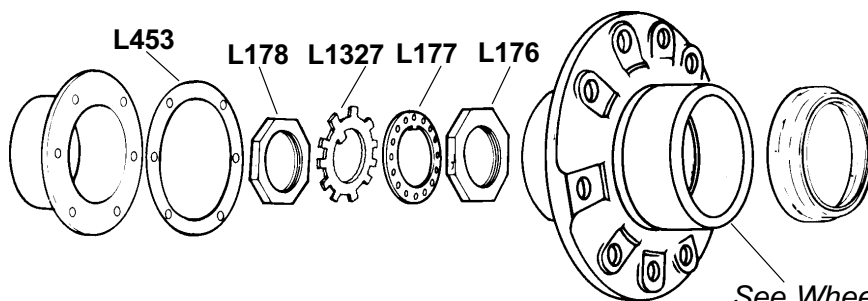

See Wheel Hub Section

BRAKE REPAIR KITS - DANA

K50

Converts 12-1/4" Dana and Standard Forge Cast
to Early FT Style Shoes or Services Existing Early
FT Conversion.

Kit Contains:

- | | |
|----------------|--------------------|
| 2 Pcs. - L118 | Lock Ring |
| 2 Pcs. - L509 | Nut |
| 2 Pcs. - L1277 | Anchor Pin |
| 2 Pcs. - L1278 | Anchor Pin Link |
| 1 Pc. - L1279 | Shoe Return Spring |
| 2 Pcs. - L1280 | Roller |
| 2 Pcs. - L1281 | Roller Pin |
| 2 Pcs. - L1287 | 3/4" Lock Washer |
| 2 Pcs. - L1370 | Lock Ring |
| 2 Pcs. - L1535 | Return Spring Pin |

Contains parts to service one wheel.

Shoes: L1282 (5-1/2") & L1283 (7-1/2")



D
A
N
A

BRAKE REPAIR KITS

DANA

K62

12-1/4" Brakes with Std. Small "S" Cams & Cast Shoes.

Kit Contains:

- 2 Pcs. - L100 Roller
- 2 Pcs. - L101 Roller Pin
- 2 Pcs. - L145 Set Screw
- 2 Pcs. - L417 Return Spring
- 2 Pcs. - L425 Bushing
- 2 Pcs. - L509 Nut
- 2 Pcs. - L728 Anchor Pin
- 1 Pc. - L1284 Link
- 2 Pcs. - L2064 Lock Ring

Contains parts to service one wheel.
To convert early model 12-1/4" from cast to pressed steel use K50.



Schematic
Diagram
Charts

4

K69

Early Design FT Style.

Kit Contains:

- 2 Pcs. - L118 Lock Ring
- 1 Pc. - L1279 Return Spring
- 2 Pcs. - L1280 Roller
- 2 Pcs. - L1281 Roller Pin
- 2 Pcs. - L1368 Anchor Pin
- 4 Pcs. - L1369 Anchor Pin Washer
- 4 Pcs. - L1370 Lock Ring
- 2 Pcs. - L1373 Anchor Pin Bushing
- 2 Pcs. - L1535 Return Spring Pin

Contains parts to service one wheel.
Shoes: L1282 (5-1/2") & L1283 (7-1/2")



K137

Early Design FC, "U" Brake.

Kit Contains:

- 2 Pcs. - L118 Lock Ring
- 1 Pc. - L1279 Shoe Return Spring
- 2 Pcs. - L1280 Roller
- 2 Pcs. - L1281 Roller Pin
- 2 Pcs. - L1535 Return Spring Pin
- 1 Pcs. - L2367 Shoe Retainer
- 2 Pcs. - L2368 Anchor Pin

Contains parts to service one wheel.
Shoes: No longer available, see schematic notes on page 20.



K277

2nd Design FT Brake Shoes using PRE "0794" "Fast Rise" Cams.

Kit Contains:

- 2 Pcs. - L149 1-1/4" Dia. Roller
- 2 Pcs. - L324 Return Spring Pin
- 2 Pcs. - L151 Roller Retainer
- 1 Pc. - L1279 Return Spring
- 2 Pcs. - L1368 Anchor Pin
- 4 Pcs. - L1369 Washer
- 4 Pcs. - L1370 Lock Ring
- 2 Pcs. - L1373 Spider Bushing

Contains parts to service one wheel.
Shoes: L2916 (5-1/2") & L2917 (7-1/2")



D
A
N
A

BRAKE REPAIR KITS

DANA

K279

Late Design FC, Using PRE "0794"
"Fast Rise" Cams.

Kit Contains:

- 2 Pcs. - L149 1-1/4" Roller
- 2 Pcs. - L324 Return Spring Pin
- 2 Pcs. - L151 Roller Retainer
- 1 Pc. - L1279 Return Spring
- 1 Pc. - L2367 Anchor Pin Retainer
- 2 Pcs. - L2368 Anchor Pin



Contains parts to service one wheel.
Shoes: L3048 (5-1/2") & L2918 (7-1/2")

Schematic
Diagram
Charts

4

K288

Converts 12-1/4" Cast Shoes to 2nd Design
FT using PRE "0794" "Fast Rise" Cams or
Services 2nd design FT Conversion using
PRE "0794" "Fast Rise" Cams.

- 2 Pcs. - L149 1-1/4" Dia. Roller
- 2 Pcs. - L151 Roller Retainer
- 2 Pcs. - L324 Return Spring Pin
- 2 Pcs. - L509 Anchor Pin Nut
- 2 Pcs. - L1277 Anchor Pin
- 2 Pcs. - L1278 Anchor Pin Link
- 1 Pc. - L1279 Shoe Return Spring
- 2 Pcs. - L1287 Anchor Pin Lock Washer
- 2 Pcs. - L1370 Lock Ring



Contains parts to service one wheel.

TIP Can convert to Late Design FC with
the addition of L2367.

Shoes: L2916 (5-1/2") & L2917 (7-1/2")

K335

2nd Design FT Style Brake Shoes using
2nd Generation "0794" "Fast Rise" Cams.

Contents:

- 2 Pcs. - L151 Roller Retainer
- 2 Pcs. - L158 1-1/2" Dia. Roller
- 2 Pcs. - L324 Return Spring Pin
- 1 Pc. - L1279 Return Spring
- 2 Pcs. - L1368 Anchor Pin
- 4 Pcs. - L1369 Washer
- 4 Pcs. - L1370 Lock Ring
- 2 Pcs. - L1373 Anchor Pin Bushing



Contains parts to service one wheel

Shoes: L2916 (5-1/2") & L2917 (7-1/2")

D
A
N
A

BRAKE REPAIR KITS

DANA

K336

Late FC Style Brake Shoes using
2nd Generation "0794"
"Fast Rise" Cams.

Contents:

- 2 Pcs. - L151 Roller Retainer
- 2 Pcs. - L158 1-1/2" Dia. Roller
- 2 Pcs. - L324 Return Spring Pin
- 1 Pc. - L1279 Return Spring
- 1 Pc. - L2367 Anchor Retainer
- 2 Pcs. - L2368 Anchor Pin

Contains parts to service one wheel
Shoes: L3048 (5-1/2") & L2918 (7-1/2")



Schematic
Diagram
Charts

4

K338

Converts Dana and Standard Forge
12-1/4" Cast to 2nd Design FT Shoes using
2nd Generation "0794" "Fast Rise" Cams.

- 2 Pcs. - L151 Roller Retainer
- 2 Pcs. - L158 1-1/2" Dia. Roller
- 2 Pcs. - L324 Return Spring Pin
- 2 Pcs. - L509 Anchor Pin Nut
- 2 Pcs. - L1277 Anchor Pin
- 2 Pcs. - L1278 Anchor Pin Link
- 1 Pc. - L1279 Return Spring
- 2 Pcs. - L1287 Anchor Pin Lock Washer
- 2 Pcs. - L1370 Lock Ring

Contains parts to service one wheel
Shoes: L2916 (5-1/2") & L2917 (7-1/2")

TIP Can convert to Late Design FC with
the addition of L2367.



D
A
N
A

K352

For Dana 12-1/4" Early Design Pivot Style
Brake using Heavy Duty Brake Return Spring

Kit Contains:

- 2 Pcs. - L118 Lock Ring
- 2 Pcs. - L1280 Roller
- 2 Pcs. - L1281 Roller Pin
- 2 Pcs. - L1368 Anchor Pin
- 4 Pcs. - L1369 Anchor Pin Washer
- 4 Pcs. - L1370 Lock Ring
- 2 Pcs. - L1373 Anchor Pin Bushing
- 2 Pcs. - L1535 Return Spring Pin
- 1 Pc. - L3148 Heavy Duty Return Spring

Contains parts to service one wheel.
Same as K69, except L3148 replaces L1279



 H. D. Version

BRAKE REPAIR KITS

DANA

K373

For 12-1/4" Dana FCII Brakes on Post
11/1/96 Axles Using L1416-Type Anchor Pins
& L1417 Anchor Retaining Springs

Contents:

- 2 Pcs. - L151 Roller Retainer
- 2 Pcs. - L158 1-1/2" Dia. Roller
- 2 Pcs. - L324 Return Spring Pin
- 2 Pcs. - L1416 Anchor Pin
- 2 Pcs. - L1417 Retainer Spring
- 2 Pcs. - L1498 Anchor Pin Bushing
- 1 Pc. - L3148 H.D. Return Spring



 Second Generation type "Fast Rise" "0794" camshafts are used as prior design.

Contains parts to service one wheel.

Schematic
Diagram
Charts

4

K377

For Retrofit of Earlier 12-1/4" "FC," "FT" & "U"
Brakes w/ Late Style FCII Shoes

Contents:

- 2 Pcs. - L151 Roller Retainer
- 2 Pcs. - L158 1-1/2" Dia. Roller
- 2 Pcs. - L324 Return Spring Pin
- 2 Pcs. - L1368 Anchor Pin
- 4 Pcs. - L1369 Anchor Pin Washer
- 4 Pcs. - L1370 Lock Ring
- 2 Pcs. - L1417 Retainer Spring
- 1 Pc. - L3148 H.D. Return Spring



 Replaces earlier style "FC", "FT", "U" shoes on pre-11/96 brake spiders with FCII type shoes using K377 contents, including 1" diameter L1368 anchor pins, L1369 spacer washers & L1370 lock rings. Second Generation "Fast Rise" "0794" type camshafts are required.

Contains parts to service one wheel.

K501

For Post 3/99 12-1/4" Dana FCII using
L3501 Single Piece Retaining Springs.

Contents:

- 2 Pcs. - L151 Roller Retainer
- 2 Pcs. - L158 Roller
- 2 Pcs. - L324 Return Spring Pin
- 2 Pcs. - L1416 Anchor Pin
- 2 Pcs. - L1498 Anchor Pin Bushing
- 1 Pc. - L3148 H.D. Return Spring
- 2 Pcs. - L3501 Retainer Spring



Contains parts to service one wheel

Install L3501 with short hook/coil end facing upward.
K501 can replace earlier version FCII (K373)
having L1417 type retainer spring.

D
A
N
A

CAM BUSHING KITS

DANA

K144

For Dana Early 12-1/4" Cast Brakes using Bolt on or Weld on Spider and Rigid Cam Bracket.

Services 10 or 28 Spline Cam, Standard and "Fast Rise" Types.

- 2 Pcs. - L120 Spacer Washer
- 2 Pcs. - L137 Lock Ring
- 1 Pc. - L166 Nylon Cam Bracket Bushing
- 1 Pc. - L389 Nylon Spider Bushing
- 1 Pc. - L397 Lock Ring (28 Spline End)
- 1 Pc. - L889 Spacer Washer (28 Spline End)
- 2 Pcs. - L966 Neoprene Seal
- 1 Pc. - L1719 Cam Head Washer



Schematic
Diagram
Charts

4

Contains parts to service one wheel

K342

For Dana Late 12-1/4" Cast Brakes using Bolt on or Weld on Spider and Spherical Cam Bracket.

Services 10 or 28 Spline Cam, Standard and "Fast Rise" Types.

- 2 Pcs. - L120 Spacer Washer
- 2 Pcs. - L137 Lock Ring
- 1 Pc. - L397 Lock Ring (28 Spline End)
- 1 Pc. - L889 Spacer Washer (28 Spline End)
- 2 Pcs. - L966 Neoprene Seal
- 1 Pc. - L1536 Nylon Spider Bushing
- 1 Pc. - L1719 Cam Head Washer
- 1 Pc. - L3146 Cam Bushing



Contains parts to service one wheel

K345

Axle Kit for Dana Late 12-1/4" Pressed Steel Brakes with Weld on Spider using Nylon Spider Bushing. Services 10 or 28 Spline Cam, Standard and "Fast Rise" Types.

- 4 Pcs. - L137 Lock Ring
- 2 Pcs. - L192 Spacer Washer
- 2 Pcs. - L193 Spacer Washer
- 2 Pcs. - L397 Lock Ring (28 Spline End)
- 2 Pcs. - L889 Spacer Washer (28 Spline End)
- 4 Pcs. - L966 Neoprene Seal
- 2 Pcs. - L1371 Spacer Washer
- 2 Pcs. - L1372 Cam "D" Washer
- 2 Pcs. - L1536 Nylon Spider Bushing
- 2 Pcs. - L3146 Cam Bushing



Use **K145** to service One Wheel End.

CAM BUSHING KITS

DANA

K347

Axle kit for Dana Late 12-1/4" Pressed Steel Brakes with Weld on Spider using Bronze Spider Bushing. Services 10 or 28 Spline Cam, Standard and "Fast Rise" Types.

- 4 Pcs - L137 Lock Ring
- 2 Pc. - L192 Spacer Washer
- 2 Pc. - L193 Spacer Washer
- 2 Pc - L397 Lock Ring (28 Spline End)
- 2 Pc. - L402 Bronze Cam Bushing
- 2 Pc. - L889 Spacer Washer (28 Spline End)
- 4 Pcs. - L966 Neoprene Seal
- 2 Pc. - L3146 Cam Bushing
- 2 Pc. - L1371 Spacer Washer
- 2 Pc. - L1372 Cam "D" Washer
- 2 Pc. - L3146 Cam Bushing



Use **K337** to service One Wheel End

Schematic
Diagram
Charts

4

K494

For Late Dana 12-1/4" or 16-1/2" Trailer Brake from 6/98 with Revised Cam Bracket Assembly Components, Axle Kit.

Contents:

- 2 Pcs. - L137 Spider End Lock Ring
- 2 Pcs. - L397 Spline End Lock Ring
- 2 Pcs. - L897 Lock Ring
- 4 Pcs. - L2941 Spider Seal
- 2 Pcs. - L3127 Camshaft Spider Bushing
- 2 Pcs. - L3178 Inboard Spacer Washer
- 2 Pcs. - L3179 Spacer Washer (28 Spline End)
- 2 Pcs. - L3364 Spider End Lock Ring
- 1 Pc. - L3484 Right Hand Bracket Assembly
- 1 Pc. - L3485 Left Hand Bracket Assembly

Services one axle.

Use **K482** to service R.H. (Curbside) Wheel End

Use **K483** to service L.H. (Roadside) Wheel End



K505

Axle Kit for 9/95 Thru 5/98 Axles using 1-5/8" I.D. Bronze Spider Bushing and Fluted Cam Bracket Bushing.

Contents:

- 2 Pcs. - L137 Spider End Lock Ring
- 2 Pcs. - L397 Spline End Lock Ring
- 2 Pcs. - L897 Lock Ring
- 4 Pcs. - L2941 Spider Seal
- 2 Pcs. - L3127 Bronze Spider Bushing
- 2 Pcs. - L3146 Cam Bracket Bushing
- 2 Pcs. - L3178 Inboard Spacer Washer
- 2 Pcs. - L3179 Spacer Washer (28 Spline End)
- 2 Pcs. - L3364 Spider End Lock Ring



Use **K355** to service One Wheel End

D
A
N
A

 H. D. Version

CAM BUSHING KITS

DANA

K507

**For Late Trailer Brake with Revised Cam
Bracket Assembly Components for Axle Right
and Left Hand Sides.**

Contents:

- 2 Pcs. - L137 Spider End Lock Ring
- 2 Pcs. - L397 Spline End Lock Ring
- 2 Pcs. - L897 Lock Ring
- 2 Pcs. - L2382 Camshaft Spider Bushing
- 4 Pcs. - L2941 Spider Seal
- 2 Pcs. - L3178 Inboard Spacer Washer
- 2 Pcs. - L3179 Spacer Washer (28 Spline End)
- 2 Pcs. - L3364 Spider End Lock Ring
- 1 Pc. - L3484 Right Hand Bracket Assembly
- 1 Pc. - L3485 Left Hand Bracket Assembly

Serves one axle.

Use **K508** to service RH (Curbside) Wheel End

Use **K509** to service LH (Roadside) Wheel End



Schematic
Diagram
Charts

4

K543

**Axle Kit for 9/95 Thru 5/98 Axles using 1-5/8"
I.D. Nylon Spider Bushing and Fluted Carr
Bracket Bushing.**

Contents:

- 2 Pcs. - L137 Spider End Lock Ring
- 2 Pcs. - L397 Spline End Lock Ring
- 2 Pcs. - L897 Lock Ring
- 2 Pcs. - L2382 Nylon Spider Bushing
- 4 Pcs. - L2941 Spider Seal
- 2 Pcs. - L3146 Cam Bracket Bushing
- 2 Pcs. - L3178 Inboard Spacer Washer
- 2 Pcs. - L3179 Spacer Washer (28 Spline End)
- 2 Pcs. - L3364 Spider End Lock Ring

Use **K514** to service One Wheel End



D
A
N
A

DANA

15" X 4" STEERING AND LIFT AXLE BRAKE

Schematic
Diagram
Charts

4

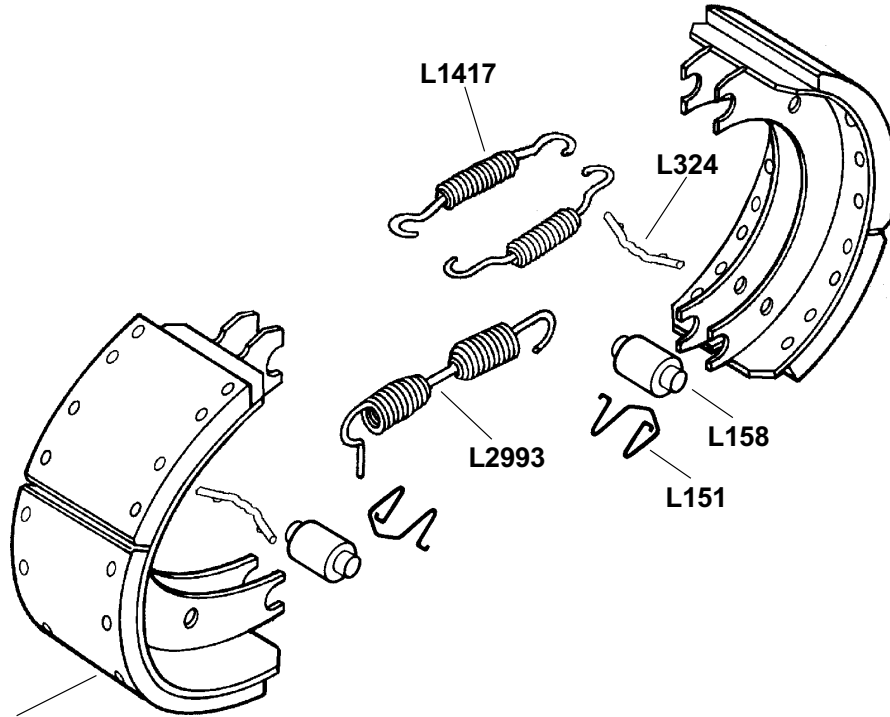

L3505 - Unlined
FMSI 4693D (4")

Brake Repair Kit: **K374**

15" X 4" CAM ASSEMBLY PARTS

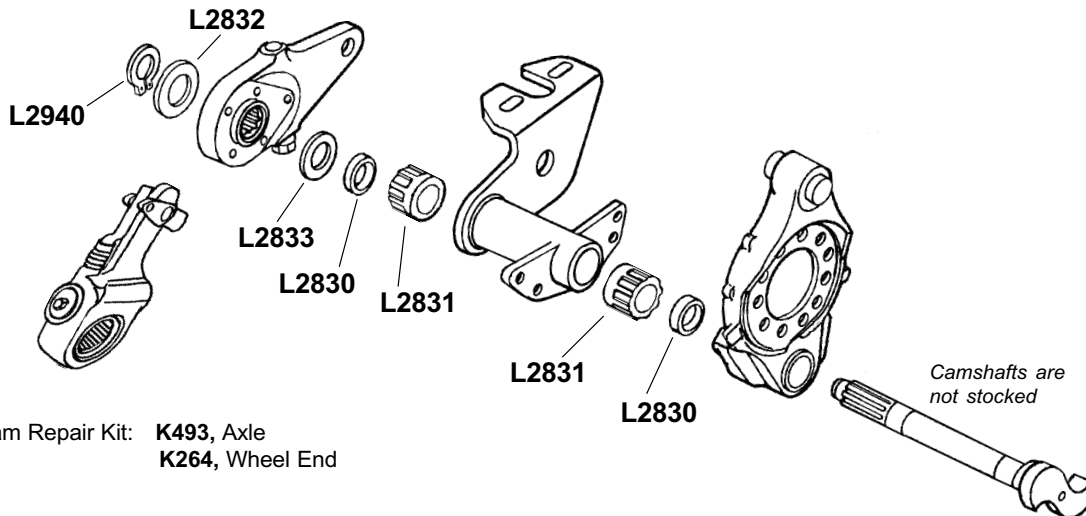

Cam Repair Kit: **K493**, Axle
K264, Wheel End

D
A
N
A

BRAKE REPAIR KITS

DANA

K374

For 15" x 4" Steer or Lift Axles Using
FMSI 4693D & 16-1/2" Drive Axle Brakes
Using 1-1/2" Diameter Roller

Contents:

- 2 Pcs. - L151 Roller Retainer
- 2 Pcs. - L158 1-1/2" Dia. Roller
- 2 Pcs. - L324 Return Spring Pin
- 2 Pcs. - L1417 Retainer Spring
- 1 Pc. - L2993 Return Spring

Contains parts to service one wheel.



Schematic
Diagram
Charts

4

CAMSHAFT REPAIR KIT

DANA

K493

For Dana 15" x 4" Steer or Lift Axle Brakes
Using FMSI 4693D

Kit Contains:

- 2 Pcs. - L1606 Lock Ring
- 4 Pcs. - L2830 Seal
- 4 Pcs. - L2831 Bushing
- 2 Pcs. - L2832 Spacer Washer
- 2 Pcs. - L2833 Spacer Washer
- 2 Pcs. - L2940 Lock Ring

Contains parts to service one axle.

Use **K264** to service One Wheel End.



D
A
N
A

LELAND REPLACEMENT PARTS FOR

DANA

16-1/2" BRAKE FC FAST CHANGE

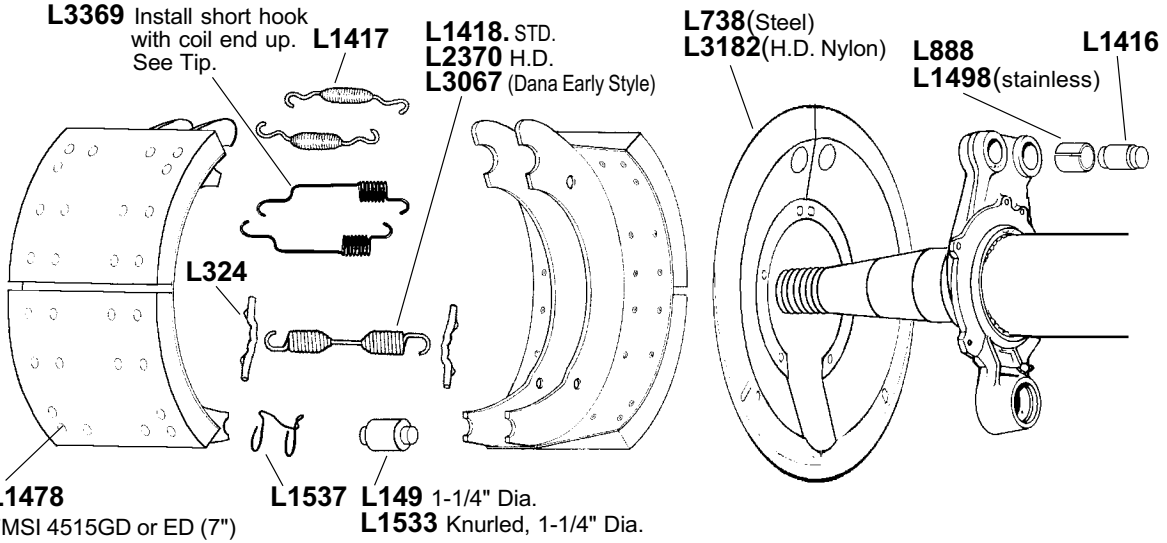

Schematic
Diagram
Charts
4

TIP L3369 type retainer springs replace L1417 type on post 3/8/99 axles for ABS sensor clearance. L3369 can retrofit earlier L1417 types.

Standard Brake Repair Kits using L1417: **K70, K70A, K117, K303, K303K, K306, K380**



Heavy Duty Brake Repair Kits using L1417: **K128, K128A, K128K, K304, K304K, K320, K329, K332, K370**

Heavy Duty Brake Repair Kits using L3369: **K500, K500K**

Heavy Duty Brake Repair Kit using L3067: **K339**

Camshafts: See page for S head identification and information chart.

"XTRA LIFE" OR "XL" 1ST SERIES USING FMSI 4701D BRAKE BLOCK

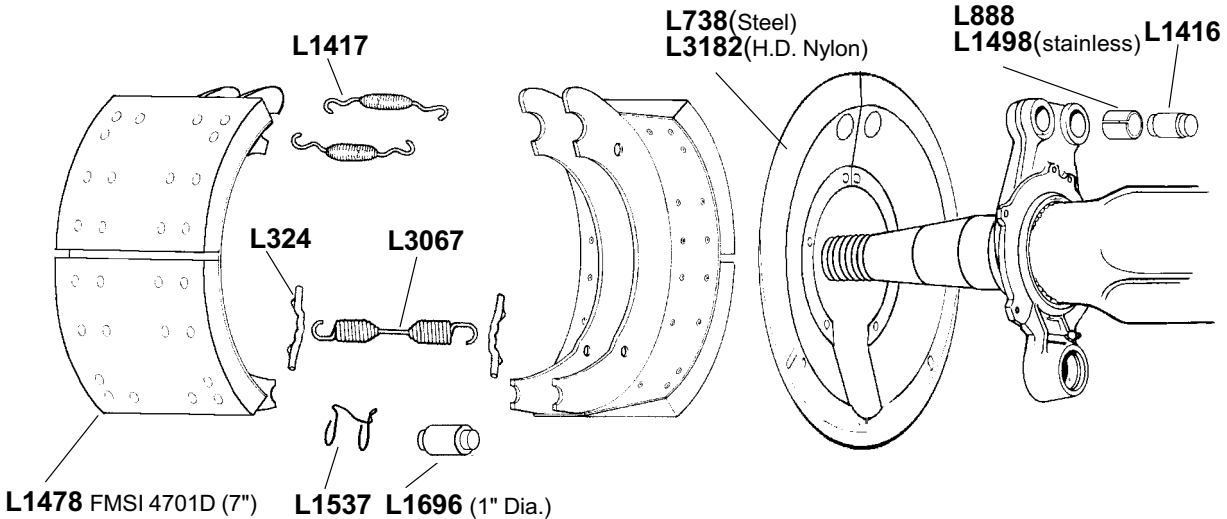

Brake Repair Kit: **K305**

Camshafts: "XTRALIFE" only, See page 39 for S head identification and information chart.



H. D. Version

DANA

16-1/2" BRAKE

"XTRALIFE II" OR "XLII", 2ND SERIES USING FMSI 4707D BRAKE BLOCK

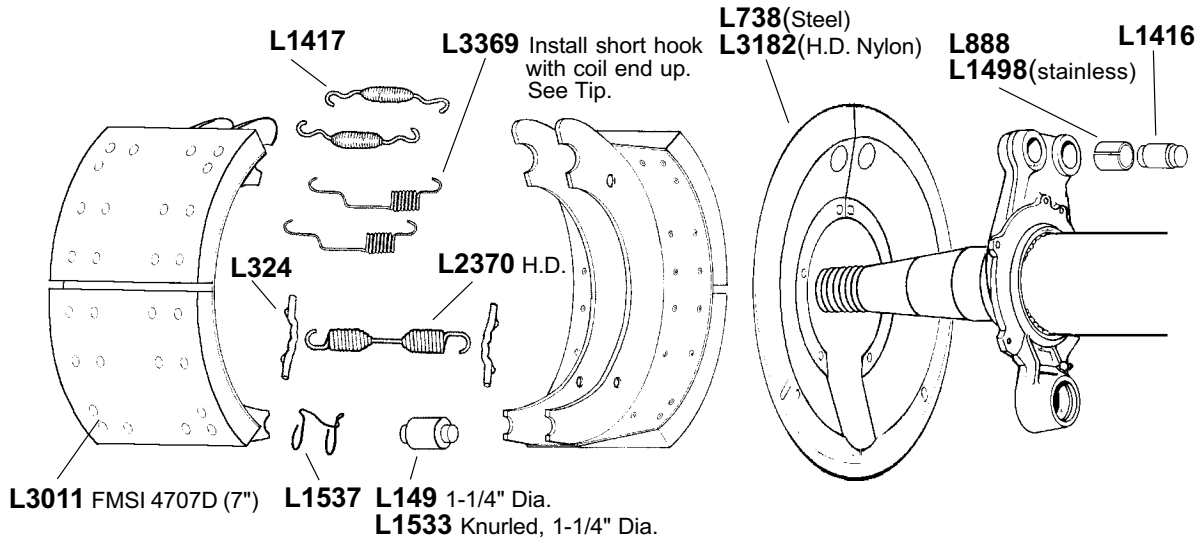

Schematic
Diagram
Charts
4

TIP XLII introduced in mid - '95 as an O.E.M option. L3369 type retainer springs replaced L1417 type on post 3/8/99 axles for ABS sensor clearance. L3369 can retrofit earlier L1417 types.



Heavy Duty Brake Repair Kits using L1417: K128, K128A, K128K, K304, K304K, K320, K329, K332
Heavy Duty Brake Repair Kits using L3369: K500, K500K

Camshafts: "XTRALIFE" and "XTRALIFE II" types. OEM "XTRALIFE II" style have 1-5/8" and 1-1/2" diameter bearing surfaces. See page 39 for S head identification and information chart.

TIP CONVERSIONS FOR DANA "FAST CHANGE" AND "XTRALIFE" BRAKES

1. FROM "FAST CHANGE" BRAKES USING FMSI 4515 BLOCK TO "XTRALIFE" OR "XTRALIFE II" TYPE BRAKES.

- A. Identify camshaft type on axle. (see cam identification chart on pg. 39) Post '90 axles used "XL" type cams for "Fast Change", "XTRALIFE" and "XTRALIFE II" Brakes.
- B. Change camshafts to "XL" types in pairs per axle, LH and RH if not present. If "XL" type cams are present, inspect and replace if worn or damaged. Install new cam bushings and other related parts using the appropriate cam repair kit(s).
- C. For "XTRALIFE" type use L1478 brake shoes lined with FMSI 4701D block and K305 brake hardware kits.
- D. For "XTRALIFE II" type use L3011 brake shoes lined with FMSI 4707D block and appropriate brake hardware kits.

2. FROM "XTRALIFE" OR "XTRALIFE II" BRAKES USING FMSI 4701D AND FMSI 4707D BLOCK TO "FAST CHANGE" TYPE USING FMSI 4515ED BLOCKS.

- A. Remove brake shoes and hardware from axle.
- B. The "XL" camshafts can be retained. If the camshafts are worn or damaged, replacement with "XL" types and the appropriate cam repair kit(s) is recommended.
- C. Install L1478 brake shoes lined with FMSI 4515ED block and appropriate brake hardware kits.

**D
A
N
A**

DANA

PRESSED STEEL 16-1/2" BRAKE

EARLY "P" OR PIVOT TYPE BRAKES

Schematic
Diagram
Charts

4

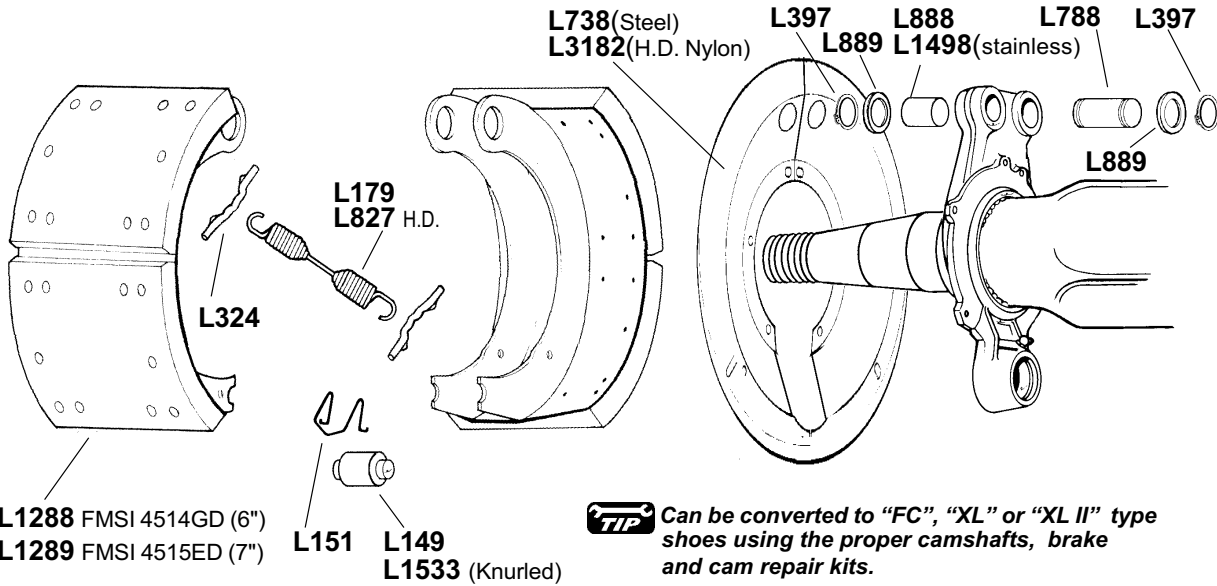

Brake Repair Kits: *Weld on spider, non-adjustable with non-slotted anchor pins:*

Standard Duty - **K60** See page 192



Heavy Duty - **K45, K109, K116** See page 194

Brake Repair Kits: *Bolt on Spider, adjustable with slotted anchor pins:*

Standard Duty - **K59, K44A** See page 192



Heavy Duty - **K44, K44B, K115** See page 193

EARLY CAST SHOES

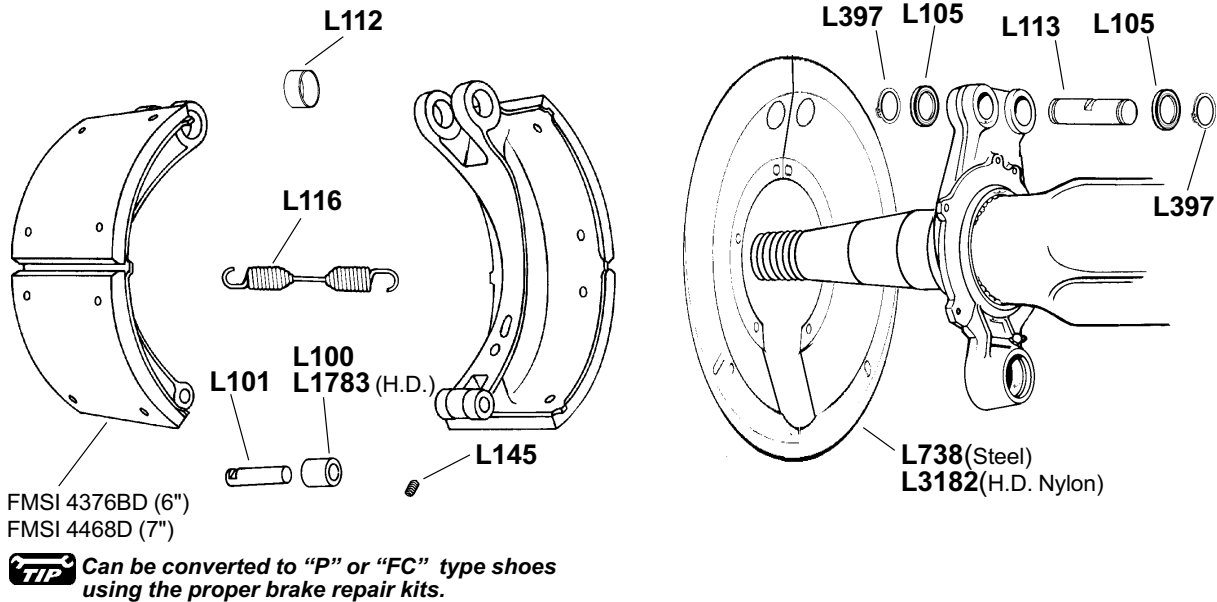

Brake Repair Kit: **K54**

H. D. Version

DANA

16-1/2" BRAKE

16-1/2" BRAKE - CAMSHAFT IDENTIFICATION

TIP IMPORTANT!

Do not mix standard and "XL" cam versions on an axle.

"FAST CHANGE" and "PIVOT" type brakes using earlier standard profile cams with 1-3/8" width S-heads heads can be retrofitted with "XL" cams in LH and RH pairs on an axle.

"XL II" trailer axle cams produced from approximately mid-'95 on have a 1-5/8" diameter bearing surface overhead and a 1-1/2" diameter bearing surface at the spline end.

Do not use earlier standard profile cams with "XL" or "XL II" brakes.

Do not use "XL" cams with 16-1/2" cast brake shoes.

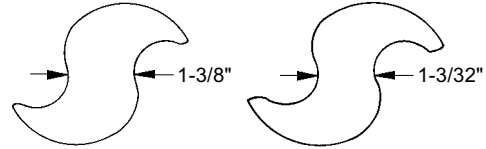

PRE-1989
Standard
"Large S"
1-1/2" diameter bearing surfaces.

POST-1989
"XL" Profile
With either 1-1/2" or 1-5/8" diameter spider bearing surface. Introduced with FMSI 4701D "XL" brakes in 1989, standardized for both "FC" & "XL" brakes in 1990. OEM cast identification located next to S-head pocket is shown as 165R or 165L.

Schematic Diagram Charts
4

CAMSHAFT ASSEMBLY PARTS FOR AXLES WITH 1-1/2" CAMSHAFT BEARING SURFACES & "FAST CHANGE" 4515 OR "XTRALIFE" 4701/4707 BRAKES.

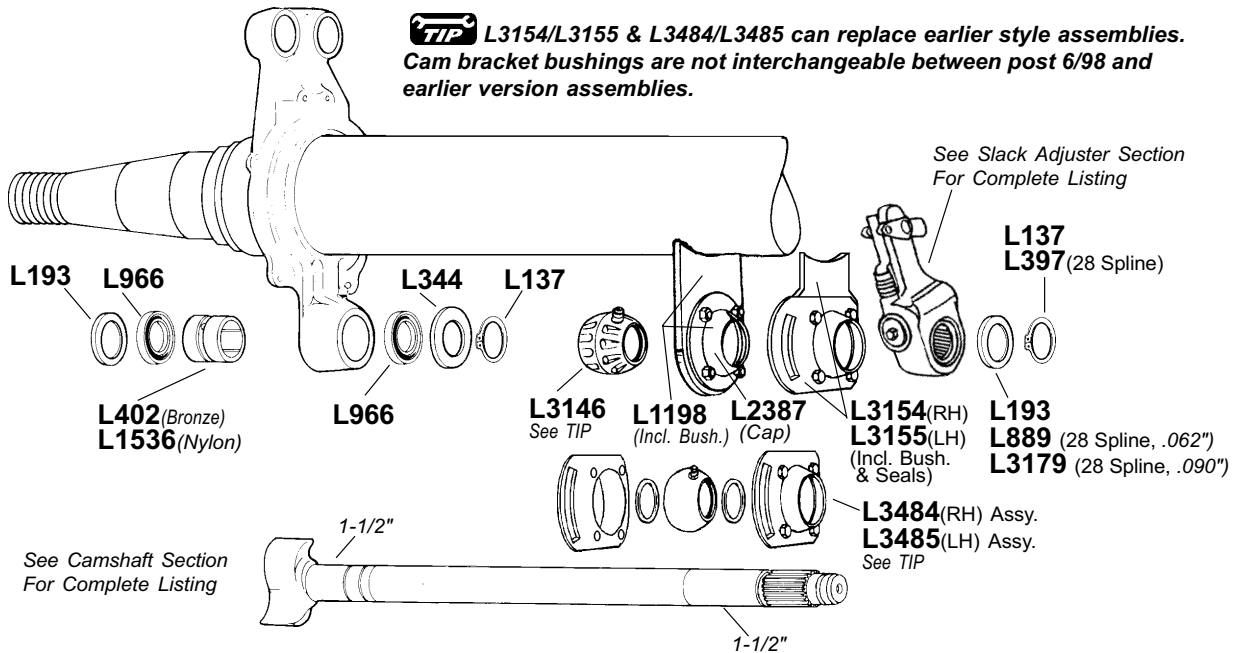

TIP L3154/L3155 & L3484/L3485 can replace earlier style assemblies. Cam bracket bushings are not interchangeable between post 6/98 and earlier version assemblies.

See Slack Adjuster Section For Complete Listing

See Camshaft Section For Complete Listing

Standard

Cam Repair Kits: **K343** - Nylon Spider Bushing, Axle.

K314 - Nylon Spider Bushing, Wheel End.



Heavy Duty Cam Repair Kits: **K348** - Bronze Spider Bushing, Axle.

K327 - Bronze Spider Bushing, Wheel End.



H. D. Version

D
A
N
A

DANA

16-1/2" BRAKE

CAMSHAFT ASSEMBLY PARTS FOR LATE TRAILER AXLES WITH 1-5/8" & 1-1/2" DIAMETER CAMSHAFT BEARING SURFACES, "FAST CHANGE" 4515, "EXTRALIFE" II 4707 OR 18" BRAKES.

Schematic Diagram Charts

4

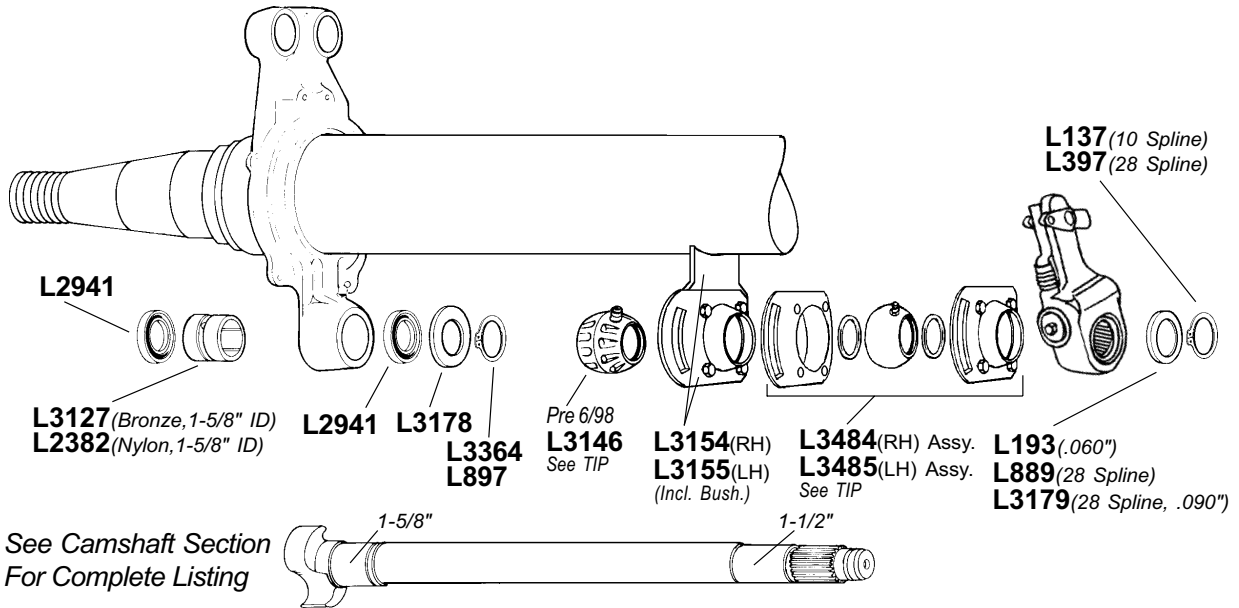

See Camshaft Section For Complete Listing

TIP L3128/L3129 & L3484/L3485 can replace earlier style assemblies. Cam bracket bushings are not interchangeable between post 6/98 and earlier version assemblies.

TIP Heavy Duty Cam Repair Kits with L3127 bronze spider bushing:
 Using L3146: **K494 Axle**
K505 Axle
K355 Wheel

Using L3484 & L3485:
K482 RH (Curbside) Wheel
K483 LH (Roadside) Wheel

Cam Repair Kits with L2382 Nylatron spider bushing:
 Using L3146: **K543 Axle**
K514 Wheel
 Using L3484 & L3485:
K507 Axle
K508 RH (Curbside) Wheel
K509 LH (Roadside) Wheel

**D
A
N
A**

WHEEL HUB & AXLE ASSEMBLY PARTS 16-1/2" BRAKES

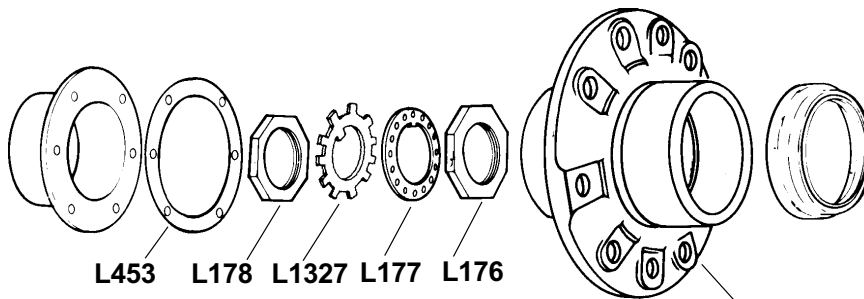

See Wheel Hub Section

BRAKE REPAIR KITS

DANA

STANDARD DUTY

K54

For 16-1/2" Cast Shoes

Kit Contains:

- 2 Pcs. – L100 Roller
- 2 Pcs. – L101 Roller Pin
- 4 Pcs. – L105 Anchor Pin Seal
- 4 Pcs. – L112 Brake Shoe Anchor Pin Bushing
- 2 Pcs. – L113 Anchor Pin
- 1 Pc. – L116 Shoe Return Spring
- 2 Pcs. – L145 Roller Pin Set Screw
- 2 Pcs. – L168 Anchor Pin Lock Screw
- 4 Pcs. – L397 Lock Ring



Contains parts to service one wheel.

Schematic
Diagram
Charts

4

K70

For Dana 16-1/2" "Fast Change"
4515 Brake.

Kit Contains:

- 2 Pcs. – L149 Roller
- 2 Pcs. – L324 Return Spring Pin
- 2 Pcs. – L1416 Anchor Pin
- 2 Pcs. – L1417 Shoe Retainer Spring
- 1 Pc. – L1418 Shoe Return Spring
- 2 Pcs. – L1498 Anchor Pin Spider Bushing
- 2 Pcs. – L1537 Roller Retainer



Contains parts to service one wheel.

Same as K117 except: uses L149 rollers in place of L1533 knurled rollers.

K70A

For Dana 16-1/2" "Fast Change"
4515 Brake.

Kit Contains:

- 2 Pcs. – L149 Roller
- 2 Pcs. – L324 Return Spring Pin
- 2 Pcs. – L1416 Anchor Pin
- 2 Pcs. – L1417 Shoe Retainer Spring
- 1 Pc. – L1418 Shoe Return Spring
- 2 Pcs. – L1537 Roller Retainer



Contains parts to service one wheel.

Same as K70 except: does not contain L1498 anchor pin bushings.

K117

For Dana 16-1/2" "Fast Change"
4515 Brake.

Kit Contains:

- 2 Pcs. – L324 Return Spring Pin
- 2 Pcs. – L1416 Anchor Pin
- 2 Pcs. – L1417 Shoe Retainer Spring
- 1 Pcs. – L1418 Shoe Return Spring
- 2 Pcs. – L1498 Anchor Pin Spider Bushing
- 2 Pcs. – L1533 Knurled Roller
- 2 Pcs. – L1537 Roller Retainer



Contains parts to service one wheel.

Same as K70 except: uses L1533 knurled rollers in place of L149 Rollers.

D
A
N
A

BRAKE REPAIR KITS

DANA

STANDARD DUTY

K306

For Dana 16-1/2" "Fast Change"
4515 Brake.

Kit Contains:

- 2 Pcs. - L149 Roller
- 2 Pcs. - L324 Return Spring Pin
- 2 Pcs. - L888 Anchor Pin Bushing
- 2 Pcs. - L1416 Anchor Pin
- 2 Pcs. - L1417 Retainer Spring
- 1 Pc. - L1418 Return Spring
- 2 Pcs. - L1537 Roller Retainer

Contains parts to service one wheel.
Same as K70 except L1498 is replaced by L888.



Schematic
Diagram
Charts

4

K303

For Dana 16-1/2" "Fast Change"
4515 Brake.

Kit Contains:

- 2 Pcs.- L149 Roller
- 2 Pcs.- L324 Return Spring Pin
- 2 Pcs.- L1417 Retainer Spring
- 1 Pc. - L1418 Return Spring
- 2 Pcs.- L1537 Roller Retainer

Contains parts to service one wheel.
Same as K70 except does not contain
L1416 anchor pins and L1498 anchor pin bushings.



K303K

For Dana 16-1/2" "Fast Change"
4515 Brake.

Kit Contains:

- 2 Pcs.- L324 Return Spring Pin
- 2 Pcs.- L1417 Retainer Spring
- 1 Pc. - L1418 Return Spring
- 2 Pcs.- L1533 Knurled Roller
- 2 Pcs.- L1537 Roller Retainer

Contains parts to service one wheel.
Same as K117 except does not contain L1416
anchor pins and L1498 anchor pin bushings.



K380

For Dana 16-1/2" "Fast Change"
4515 Brake.

Contents:

- 2 Pcs. - L324 Return Spring Pin
- 2 Pcs. - L1417 Retainer Spring
- 1 Pc. - L1418 Return Spring
- 2 Pcs. - L1537 Roller Retainer

Contains parts to service one wheel.



D
A
N
A

 H. D. Version

BRAKE REPAIR KITS

DANA

HEAVY DUTY

K128

For Dana 16-1/2" "Fast Change"
4515 and "XTRALIFE II" 4707 Brake.

Kit Contains:

- 2 Pcs. - L149 Roller
- 2 Pcs. - L324 Return Spring Pin
- 2 Pcs. - L1416 Anchor Pin
- 2 Pcs. - L1417 Retainer Spring
- 2 Pcs. - L1498 Anchor Pin Bushing
- 2 Pcs. - L1537 Roller Retainer
- 1 Pcs. - L2370 HD Return Spring

Contains parts to service one wheel.



Schematic
Diagram
Charts

4

K128K

For Dana 16-1/2" "Fast Change"
4515 and "XTRALIFE II" 4707 Brake.

Kit Contains:

- 2 Pcs. - L324 Return Spring Pin
- 2 Pcs. - L1416 Anchor Pin
- 2 Pcs. - L1417 Shoe Retainer Spring
- 2 Pcs. - L1498 Anchor Pin Spider Bushing
- 2 Pcs. - L1533 Knurled Roller
- 2 Pcs. - L1537 Roller Retainer
- 1 Pcs. - L2370 Shoe Return Spring

Contains parts to service one wheel.

Same as K128 except L149 roller is replaced by
L1533 knurled roller.



K329

For Dana 16-1/2" "Fast Change"
4515 and "XTRALIFE II" 4707 Brake.

Kit Contains:

- 2 Pcs. - L151 Roller Retainer
- 2 Pcs. - L324 Return Spring Pin
- 2 Pcs. - L888 Anchor Pin Spider Bushing
- 2 Pcs. - L1416 Anchor Pin
- 2 Pcs. - L1417 Shoe Retainer Spring
- 2 Pcs. - L1533 Knurled Roller
- 1 Pcs. - L2370 Shoe Return Spring

Contains parts to service one wheel.

Same as K128K except L1537 is replaced by L151
and L1498 is replaced by L888.



D
A
N
A

BRAKE REPAIR KITS

DANA

HEAVY DUTY

K332

For Dana 16-1/2" "Fast Change"
4515 and "XTRALIFE II" 4707 Brake.

Kit Contains:

- 2 Pcs. - L149 Roller
- 2 Pcs. - L151 Roller Retainer
- 2 Pcs. - L324 Return Spring Pin
- 2 Pcs. - L888 Anchor Pin Spider Bushing
- 2 Pcs. - L1416 Anchor Pin
- 2 Pcs. - L1417 Shoe Retainer Spring
- 1 Pc. - L2370 Shoe Return Spring



Contains parts to service one wheel.

Same as K128 except L1537 is replaced by L151
and L1498 is replaced by L888.

Schematic
Diagram
Charts

4

K305

For Dana 16-1/2" "XTRALIFE" 4701 Brake.

Kit Contains:

- 2 Pcs. - L324 Return Spring Pin
- 2 Pcs. - L1416 Anchor Pin
- 2 Pcs. - L1417 Retainer Spring
- 2 Pcs. - L1498 Anchor Pin Bushing
- 2 Pcs. - L1537 Roller Retainer
- 2 Pcs. - L1696 1" Dia. Roller
- 1 Pc. - L3067 HD Return Spring



Contains parts to service one wheel.

K339

For Dana 16-1/2" "Fast Change"
4515 Brakes Using Shorter Length L3067
Return Spring.

Contents:

- 2 Pcs. - L149 Roller
- 2 Pcs. - L324 Return Spring Pin
- 2 Pcs. - L1416 Anchor Pin
- 2 Pcs. - L1417 Retainer Spring
- 2 Pcs. - L1498 Anchor Pin Bushing
- 2 Pcs. - L1537 Roller Retainer
- 1 Pc. - L3067 Return Spring



Contains parts to service one wheel

D
A
N
A

 H. D. Version

BRAKE REPAIR KITS

DANA HEAVY DUTY

K304

For Dana 16-1/2" "Fast Change"
4515 and "XTRALIFE II" 4707 Brake.

Kit Contains:

- 2 Pcs. - L149 Roller
- 2 Pcs. - L324 Return Spring Pin
- 2 Pcs. - L1417 Retainer Spring
- 2 Pcs. - L1537 Roller Retainer
- 1 Pc. - L2370 H.D. Return Spring

Contains parts to service one wheel.
Same as K128 except does not contain
L1416 anchor pins and L1498 anchor pin bushings.

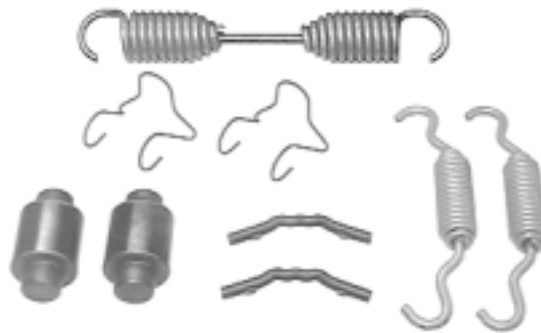

Schematic
Diagram
Charts

4

K304K

For Dana 16-1/2" "Fast Change"
4515 and "XTRALIFE II" 4707 Brake.

Kit Contains:

- 2 Pcs. - L1533 Knurled Roller
- 2 Pcs. - L324 Return Spring Pin
- 2 Pcs. - L1417 Retainer Spring
- 2 Pcs. - L1533 Knurled Roller
- 2 Pcs. - L1537 Roller Retainer
- 1 Pc. - L2370 H.D. Return Spring

Contains parts to service one wheel.
Same as K304 except L149 roller is replaced by
L1533 knurled roller.

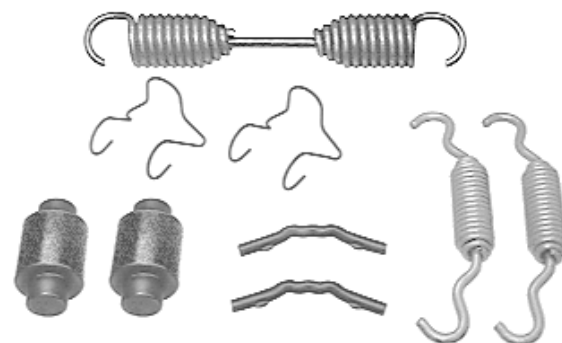

K320

For Dana 16-1/2" "Fast Change"
4515 and "XTRALIFE II" 4707 Brake.

Kit Contains:

- 2 Pcs. - L1417 Retainer Spring
- 1 Pc. - L2370 H.D. Return Spring

Contains parts to service one wheel.



K370

For Dana 16-1/2" "Fast Change"
4515 and "XTRALIFE II" 4707 Brake.

Kit Contains:

- 2 Pcs. - L149 Roller
- 2 Pcs. - L1417 Shoe Retainer Spring
- 1 Pc. - L2370 Shoe Return Spring

Contains parts to service one wheel.



 H. D. Version

BRAKE REPAIR KITS

DANA

HEAVY DUTY

K128A

For Dana 16-1/2" "Fast Change"
4515 and "XTRALIFE II" 4707 Brake.

Contains:

- 2 Pcs. - L149 Roller
- 2 Pcs. - L324 Return Spring Pin
- 2 Pcs. - L1416 Anchor Pin
- 2 Pcs. - L1417 Shoe Retainer Spring
- 2 Pcs. - L1537 Roller Retainer
- 1 Pc. - L2370 HD Return Spring



Contains parts to service one wheel.
Same as K128 except does not contain
L1498 anchor pin bushings.

K500

For Post 3/99 16-1/2" Dana FC (4515 Type)
and XLII (4707 Type)
with Single Piece Retaining Springs.

Contains:

- 2 Pcs. - L149 Roller
- 2 Pcs. - L151 Roller Retainer
- 2 Pcs. - L324 Return Spring Pin
- 2 Pcs. - L1416 Anchor Pin
- 2 Pcs. - L1498 Anchor Pin Bushing
- 1 Pc. - L2370 H.D. Return Spring
- 2 Pcs. - L3369 Retainer Spring



Contains parts to service one wheel
Install L3369 with short hook/coil end facing upward.

K500K

For Post 3/99 16-1/2" Dana FC (4515 Type)
and XLII (4707 Type)
with Single Piece Retaining Springs.

Contains:

- 2 Pcs. - L151 Roller Retainer
- 2 Pcs. - L324 Return Spring Pin
- 2 Pcs. - L1416 Anchor Pin
- 2 Pcs. - L1498 Anchor Pin Bushing
- 2 Pcs. - L1533 Knurled Roller
- 1 Pc. - L2370 H.D. Return Spring
- 2 Pcs. - L3369 Retainer Spring



Contains parts to service one wheel
Same as K500 except L149 smooth roller is replaced by L1533
knurled roller.
Install L3369 with short hook/coil end facing upward.

Schematic
Diagram
Charts

4

D
A
N
A

 H. D. Version

CAM REPAIR KITS

DANA

K151

For Dana Early Models using Spherical Cam Support Bracket.

Contains:

- 2 Pcs. - L137 Lock Ring
- 1 Pc. - L193 Spacer Washer
- 1 Pc. - L202 "D" Washer
- 1 Pc. - L344 Spacer Washer
- 1 Pc. - L1536 Spider Bushing
- 1 Pc. - L1711 Cam Bushing
- 2 Pcs. - L1729 "O" Ring
- 2 Pcs. - L1770 Seal



Contains parts to service one wheel.

Can also be serviced with **K314**, **K327**, **K343** or **K349**.

Schematic
Diagram
Charts

4

K346

Axle Kit for Dana Early Models using Rigid Cam Support Bracket.

Contents:

- 4 Pcs. - L137 Lock Ring
- 2 Pcs. - L166 Nylon Cam Bracket Bushing
- 2 Pcs. - L193 Spacer Washer
- 2 Pcs. - L202 "D" Washer
- 4 Pcs. - L329 Neoprene Seal
- 2 Pcs. - L344 Spacer Washer
- 2 Pcs. - L1536 Nylon Spider Bushing
- 4 Pcs. - L1770 Neoprene Seal



Use **K146** to service One Wheel End.

K343

Axle Kit for Dana Late 16-1/2" Brakes using Nylon Spider Bushing. Services 10 or 28 Spline, 1-1/2" Cam, Standard and "XL" Types.

Contents:

- 4 Pcs. - L137 Lock Ring
- 2 Pcs. - L193 Spacer Washer
- 2 Pcs. - L344 Spacer Washer
- 2 Pcs. - L397 Lock Ring (28 Spline End)
- 2 Pcs. - L889 Spacer Washer (28 Spline End)
- 4 Pcs. - L966 Neoprene Seal
- 2 Pcs. - L1371 Spacer Washer
- 2 Pcs. - L1536 Nylon Spider Bushing
- 2 Pcs. - L3146 Cam Bracket Bushing



Use **K314** to service One Wheel End.

D
A
N
A

CAM REPAIR KITS

DANA

K348

**Axle Kit for Dana Late 16-1/2"
Brakes using Bronze Spider Bushing.
Services 10 or 28 Spline, 1-1/2" Cam,
Standard and "XL" Types.**

Contents:

- 4 Pcs. - L137 Lock Ring
- 2 Pcs. - L192 Spacer Washer
- 2 Pcs. - L193 Spacer Washer
- 2 Pcs. - L397 Lock Ring (28 Spline End)
- 2 Pcs. - L402 Bronze Spider Bushing
- 2 Pcs. - L889 Spacer Washer (28 Spline End)
- 4 Pcs. - L966 Neoprene Seal
- 2 Pcs. - L3146 Cam Bracket Bushing



Use **K327** to service One Wheel End.

Schematic
Diagram
Charts

4

K494

**For Late Dana 12-1/4" or 16-1/2" Trailer Brake
from 6/98 with Revised Cam Bracket
Assembly Components, Axle Kit.**

Contents:

- 2 Pcs. - L137 Spider End Lock Ring
- 2 Pcs. - L397 Spline End Lock Ring
- 2 Pcs. - L897 Lock Ring
- 4 Pcs. - L2941 Spider Seal
- 2 Pcs. - L3127 Camshaft Spider Bushing
- 2 Pcs. - L3178 Inboard Spacer Washer
- 2 Pcs. - L3179 Spacer Washer (28 Spline End)
- 2 Pcs. - L3364 Spider End Lock Ring
- 1 Pc. - L3484 Right Hand Bracket Assembly
- 1 Pc. - L3485 Left Hand Bracket Assembly



Services one axle.

Use **K482** to service R.H. (Curbside) Wheel End

Use **K483** to service L.H. (Roadside) Wheel End

D
A
N
A

K505

**Axle Kit for 9/95 Thru 5/98 Axles using 1-5/8" I.D.
Bronze Spider Bushing and Fluted Cam Bracket
Bushing.**

Contents:

- 2 Pcs. - L137 Spider End Lock Ring
- 2 Pcs. - L397 Spline End Lock Ring
- 2 Pcs. - L897 Lock Ring
- 4 Pcs. - L2941 Spider Seal
- 2 Pcs. - L3127 Bronze Spider Bushing
- 2 Pcs. - L3146 Cam Bracket Bushing
- 2 Pcs. - L3178 Inboard Spacer Washer
- 2 Pcs. - L3179 Spacer Washer (28 Spline End)
- 2 Pcs. - L3364 Spider End Lock Ring



Use **K355** to service One Wheel End

CAM REPAIR KITS

DANA

K507

**For Late Trailer Brake with Revised Cam
Bracket Assembly Components for Axle Right
and Left Hand Sides.**

Contents:

- 2 Pcs. - L137 Spider End Lock Ring
- 2 Pcs. - L397 Spline End Lock Ring
- 2 Pcs. - L897 Lock Ring
- 2 Pcs. - L2382 Camshaft Spider Bushing
- 4 Pcs. - L2941 Spider Seal
- 2 Pcs. - L3178 Inboard Spacer Washer
- 2 Pcs. - L3179 Spacer Washer (28 Spline End)
- 2 Pcs. - L3364 Spider End Lock Ring
- 1 Pc. - L3484 Right Hand Bracket Assembly
- 1 Pc. - L3485 Left Hand Bracket Assembly

Services one axle.

Use **K508** to service RH (Curbside) Wheel End

Use **K509** to service LH (Roadside) Wheel End



Schematic
Diagram
Charts

4

K543

**Axle Kit for 9/95 Thru 5/98 Axles using 1-5/8"
I.D. Nylon Spider Bushing and Fluted Cam
Bracket Bushing.**

Contents:

- 2 Pcs. - L137 Spider End Lock Ring
- 2 Pcs. - L397 Spline End Lock Ring
- 2 Pcs. - L897 Lock Ring
- 2 Pcs. - L2382 Nylon Spider Bushing
- 4 Pcs. - L2941 Spider Seal
- 2 Pcs. - L3146 Cam Bracket Bushing
- 2 Pcs. - L3178 Inboard Spacer Washer
- 2 Pcs. - L3179 Spacer Washer (28 Spline End)
- 2 Pcs. - L3364 Spider End Lock Ring

Use **K514** to service One Wheel End



D
A
N
A