

DEXTER

12-1/4" TRAILER BRAKE, 10K THRU 25K AXLES

EARLY DESIGN PIVOT STYLE BRAKES

Schematic
Diagram
Charts
4

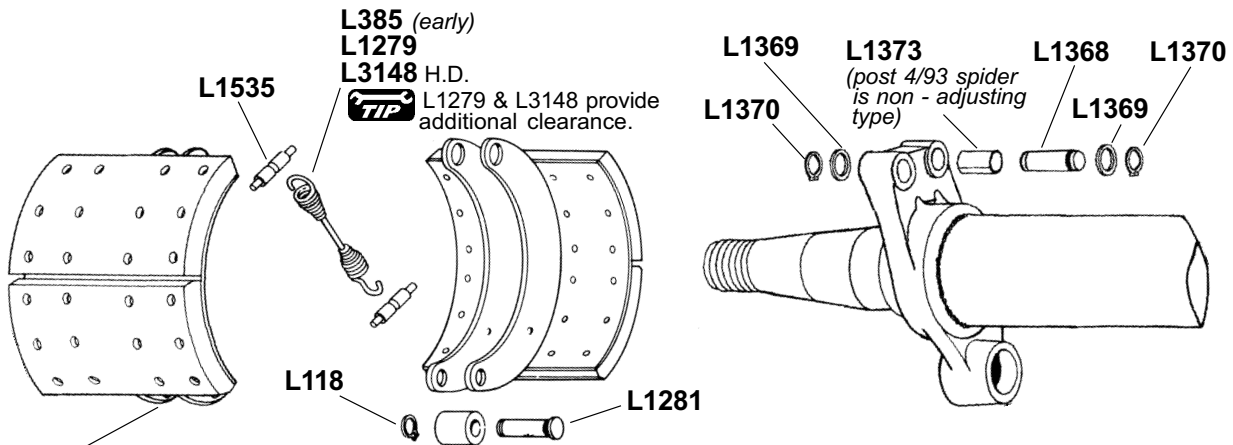

L3014 FMSI 4700D (4", 10K Axle)

L3015 FMSI 4661CD (5", 12K, 15K Axles)

L3147 FMSI 4591D (7-1/2", 20-25K Axles)

TIP Caution: Use of similar Dana/SFA type brake shoes is not recommended due to differences in shoe and spider anchor hole positioning. Do not use Dexter shoes on other manufacturer's axles.

L1280 1-1/2" Dia.

L2943 1-5/8" Dia., 1/8" oversize.

Brake Repair Kit: **K69**



Heavy Duty Brake Repair Kit: **K352**

Camshafts: **TIP** Earlier style Pivot type brakes use 10 spline cams with a standard small S type head profile. The later design 28 spline camshaft with revised head profile can be used in pairs (LH & RH) on an axle. This version is recommended when automatic slack adjusters are used. See camshaft S-head identification & information chart on page 51.

LATE DESIGN QUICK MAINTENANCE STYLE BRAKE (1/95 - 5/96)

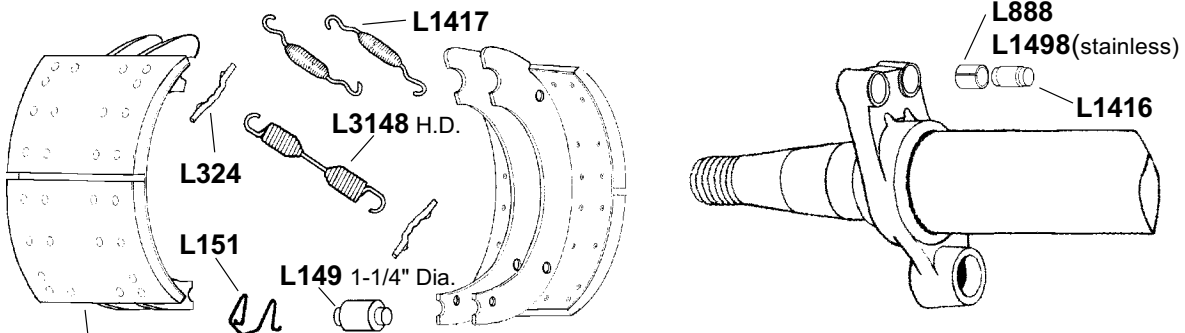

Discontinued, See Tip

L3156 FMSI 4700D (4", 10K Axle)

L3157 FMSI 4661CD (5", 12K, 15K Axles)

L3158 FMSI 4536BD (5-1/2")

L3159 FMSI 4591D (7-1/2", 20-25K Axles)



Heavy Duty Brake Repair Kit: **K353**

TIP Quick Maintenance Style brake shoes have been discontinued. For Replacement Use Late design "PQ" style shoes with K369 brake repair kit. Using the same type of brake shoes on an axle is recommended. See "PQ" schematic for additional information. Do not substitute other manufacturer's shoes on Dexter axles.

Camshafts: "Hi-Rise" Revised S-head profile, 28 spline.

See camshaft S-head identification & information chart on page 51.

H. D. Version

DEXTER

12-1/4" TRAILER BRAKE, 10K THRU 25K AXLES

LATE DESIGN "PQ" STYLE BRAKE (POST 5/96)

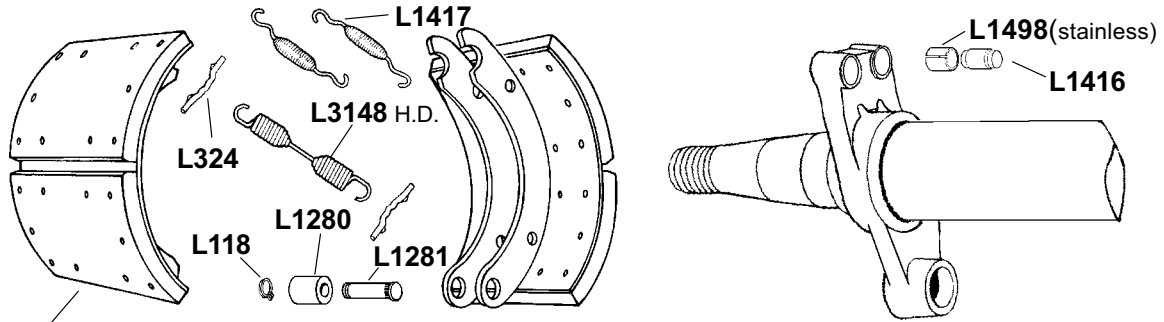

- L3354** FMSI 4700D (4", 10K Axle)
- L3355** FMSI 4661CD (5", 12K, 15K Axles)
- L3362** FMSI 4536BD (5-1/2")
- L3357** FMSI 4591D (7-1/2", 20-25K Axles)

TIP Conversion from Early Pivot Brake to "PQ" Brake:
 Retrofitting Early Pivot Style Brakes can be done only on axles using non-adjustable brake spiders. The spiders do not use a retaining bolt at the anchor pin housing. L1498 (K369) anchor pin bushings must replace the existing powdered metal bushing in the conversion. "Hi-Rise" cams must be used in pairs (LH & RH) per axle with new cam repair kits. Heavy duty cam repair kits K347 (axle) & K337 (wheel) with L402 bronze spider bushings are recommended for use with automatic slack adjusters.

Heavy Duty Brake Repair Kit: **K369**
 Camshafts: "Hi-Rise" Revised S-head profile, 28 spline.
 See camshaft S-head identification & information chart below.

Schematic
 Diagram
 Charts

4

12-1/4" BRAKE - CAMSHAFT IDENTIFICATION

IMPORTANT!
TIP DO NOT MIX DIFFERENT CAM VERSIONS OR DIFFERENT SIZE CAM ROLLERS ON AN AXLE.

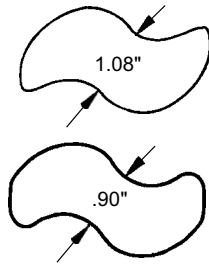

Standard size small S-head, 10 spline version. This head profile was also used on other axle manufacturer's camshafts including early Dana & Standard Forge.

"Hi-Rise", 28 spline version introduced with the implementation of automatic slack adjuster requirements. This type head profile was also used on Dana 1st generation "Fast Rise" cams. O.E.M. 28 spine camshafts are identified with DXHL or DXHR markings on the cam S-head.

12-1/4" BRAKE WITH ADJ. OR NON-ADJ. SPIDERS

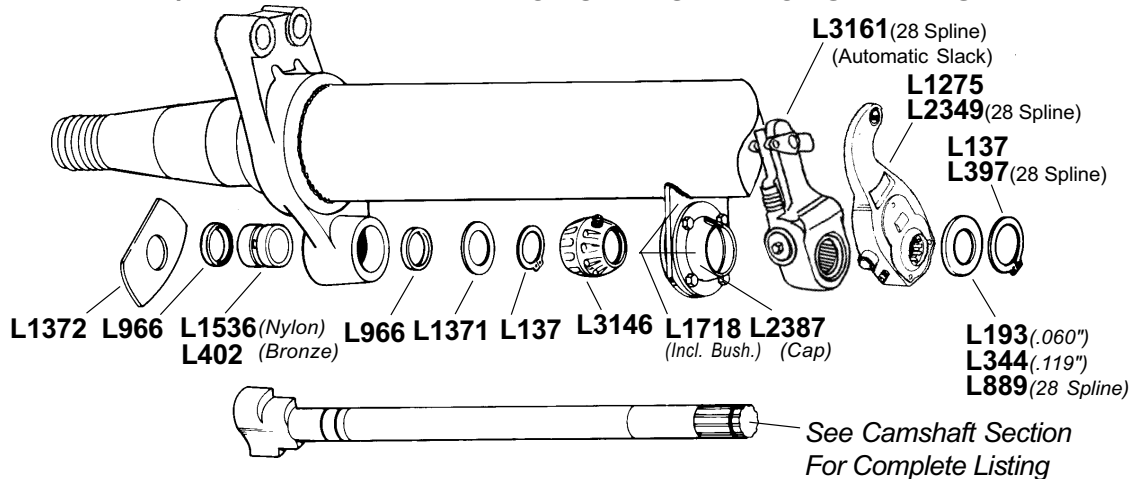

Cam Repair Kits with nylon spider bushing: **K345 Axle, K145 Wheel**

Heavy Duty Cam Repair Kits with bronze spider bushing: **K347 Axle, K337 Wheel**

H. D. Version

DEXTER

12-1/4" TRAILER BRAKE, 10K THRU 25K AXLES

WHEEL HUB & AXLE ASSEMBLY PARTS

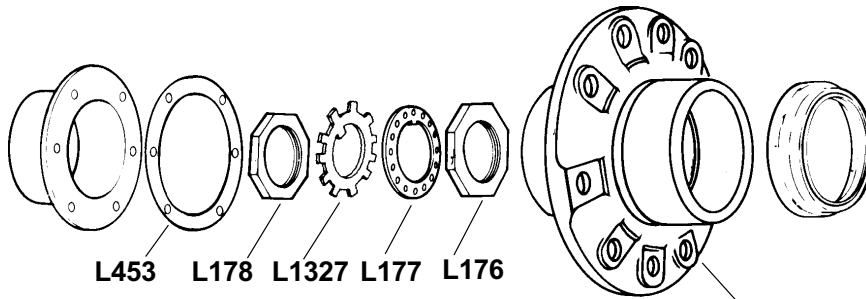

Schematic
Diagram
Charts

4

See Wheel Hub Section

BRAKE REPAIR KITS - DEXTER

K69

For Dexter 12-1/4" Early Design Pivot Style
Brake using Standard Duty Brake Return Spring

Kit Contains:

- 2 Pcs. - L118 Lock Ring
- 1 Pc. - L1279 Return Spring
- 2 Pcs. - L1280 Roller
- 2 Pcs. - L1281 Roller Pin
- 2 Pcs. - L1368 Anchor Pin
- 4 Pcs. - L1369 Anchor Pin Washer
- 4 Pcs. - L1370 Lock Ring
- 2 Pcs. - L1373 Anchor Pin Bushing
- 2 Pcs. - L1535 Return Spring Pin



Contains parts to service one wheel.

Shoes: L3014 (4"), L3015 (5") & L3147 (7-1/2")

K352

For Dexter 12-1/4" Early Design Pivot Style
Brake using Heavy Duty Brake Return Spring

Kit Contains:

- 2 Pcs. - L118 Lock Ring
- 2 Pcs. - L1280 Roller
- 2 Pcs. - L1281 Roller Pin
- 2 Pcs. - L1368 Anchor Pin
- 4 Pcs. - L1369 Anchor Pin Washer
- 4 Pcs. - L1370 Lock Ring
- 2 Pcs. - L1373 Anchor Pin Bushing
- 2 Pcs. - L1535 Return Spring Pin
- 1 Pc. - L3148 Heavy Duty Return Spring



Contains parts to service one wheel.

Same as K69, except L3148 replaces L1279

DEXTER

BRAKE REPAIR KITS

DEXTER

K353

For Dexter 12-1/4" Late Design Quick Maintenance Style Brakes Using Heavy Duty Return Spring

Contents:

- 2 Pcs. - L149 Roller
- 2 Pcs. - L151 Roller Retainer
- 2 Pcs. - L324 Return Spring Pin
- 2 Pcs. - L1416 Anchor Pin
- 2 Pcs. - L1417 Retainer Spring
- 2 Pcs. - L1498 Anchor Pin Bushing
- 1 Pc.- L3148 Heavy Duty Return Spring

Contains parts to service one wheel.

Shoes: L3156 (4"), L3157 (5"), L3158 (5-1/2") & L3159 (7-1/2")



K369

For Dexter 12-1/4" Late Design "PQ" Brakes Using Heavy Duty Return Spring.

Contents:

- 2 Pcs. - L118 Lock Ring
- 2 Pcs. - L324 Return Spring Pin
- 2 Pcs. - L1280 Roller
- 2 Pcs. - L1281 Roller Pin
- 2 Pcs. - L1416 Anchor Pin
- 2 Pcs. - L1417 Retainer Spring
- 2 Pcs. - L1498 Anchor Pin Bushing
- 1 Pc.- L3148 Heavy Duty Return Spring

Contains parts to service one wheel.

Shoes: L3354 (4"), L3355 (5"), L3362 (5-1/2") & L3357 (7-1/2")



Schematic
Diagram
Charts

4

CAM REPAIR KITS - DEXTER

K345

Axle Kit for Dexter 12-1/4" Brakes using Nylon Spider Bushing. Services 10 or 28 Spline Cam, Standard and "Hi-Rise" Types.

- 4 Pcs. - L137 Lock Ring
- 2 Pcs. - L192 Spacer Washer
- 2 Pcs. - L193 Spacer Washer
- 2 Pcs. - L397 Lock Ring (28 Spline End)
- 2 Pcs. - L889 Spacer Washer (28 Spline End)
- 4 Pcs. - L966 Neoprene Seal
- 2 Pcs. - L1371 Spacer Washer
- 2 Pcs. - L1372 Cam "D" Washer
- 2 Pcs. - L1536 Nylon Spider Bushing
- 2 Pcs. - L3146 Cam Bushing

Use **K145** to service One Wheel End.



K347

Axle kit for Dexter 12-1/4" Brakes using Bronze Spider Bushing. Services 10 or 28 Spline Cam, Standard and "Hi-Rise" Types.

- 4 Pcs. - L137 Lock Ring
- 2 Pc. - L192 Spacer Washer
- 2 Pc. - L193 Spacer Washer
- 2 Pc. - L397 Lock Ring (28 Spline End)
- 2 Pc. - L402 Bronze Cam Bushing
- 2 Pc. - L889 Spacer Washer (28 Spline End)
- 4 Pcs. - L966 Neoprene Seal
- 2 Pc. - L1371 Spacer Washer
- 2 Pc. - L1372 Cam "D" Washer
- 2 Pc. - L3146 Cam Bushing

Use **K337** to service One Wheel End



DEXTER

LELAND REPLACEMENT PARTS FOR
DEXTER
 16-1/2" x 7" TRAILER BRAKES

Schematic
 Diagram
 Charts
4

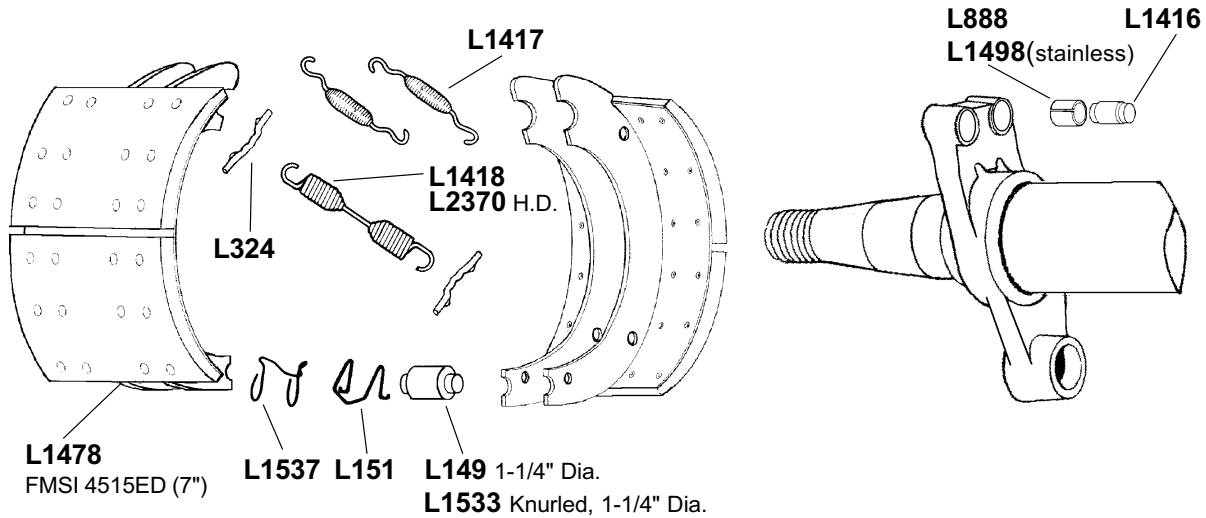

Brake Repair Kits: K70, K70A, K117, K303, K306.

Heavy Duty Brake Repair Kits: K128, K128A, K128K, K304, K304K, K320, K329, K332.

Camshafts: **TIP** Earlier type brakes were fitted with 10 spline cams with a standard S type head profile. The later design "HI-RISE" 28 spline camshaft with revised head profile can be used in pairs (LH & RH) on an axle. This version is recommended when automatic slack adjusters are used.

16-1/2" BRAKE - CAMSHAFT IDENTIFICATION

IMPORTANT!

DO NOT MIX DIFFERENT CAM VERSIONS OR DIFFERENT SIZE CAM ROLLERS ON AN AXLE.

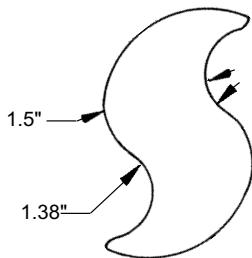

Standard "Large S"
 1-1/2" - 10 Spline
 Early Models

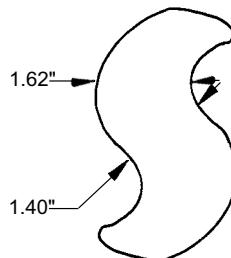

"Hi-Rise" Revised Profile
 1-1/2" - 28 Spline
 Introduced 10/94
 Marked DXHL or DXHR on the
 cast surfaces between the S-head
 pockets and cam bearing surface.

DEXTER



LELAND REPLACEMENT PARTS FOR
DEXTER
16-1/2" x 7" TRAILER BRAKES
CAMSHAFT ASSEMBLY PARTS

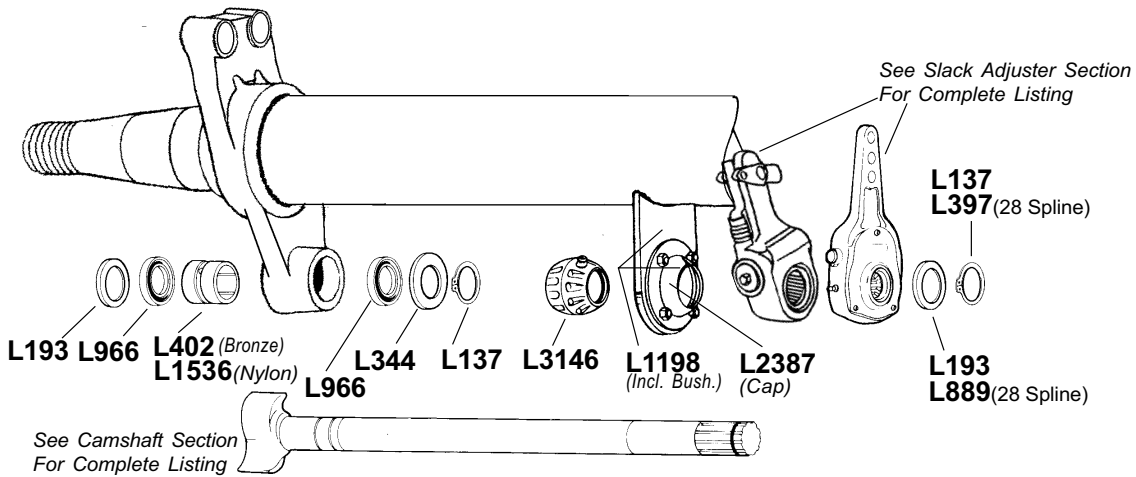

Schematic
 Diagram
 Charts
4

Cam Repair Kits: **K343** - Nylon Spider Bushing, Axle.
K314 - Nylon Spider Bushing, Wheel End.
 Heavy Duty Cam Repair Kits: **K348** - Bronze Spider Bushing, Axle.
K327 - Bronze Spider Bushing, Wheel End.

WHEEL HUB & AXLE ASSEMBLY PARTS

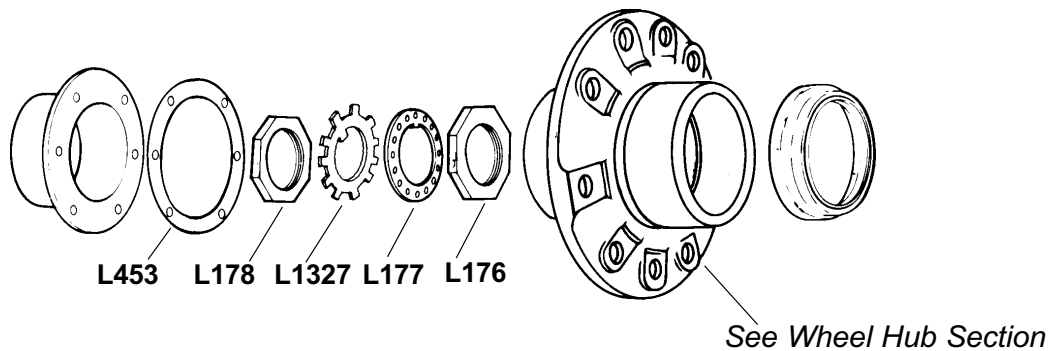

**D
 E
 X
 T
 E
 R**

 **H. D. Version**

BRAKE REPAIR KITS

DEXTER STANDARD DUTY

K70

For Dexter 16-1/2" Quick Maintenance
Type Brakes using Standard Duty
Return Spring.

Kit Contains:

- 2 Pcs. - L149 Roller
- 2 Pcs. - L324 Return Spring Pin
- 2 Pcs. - L1416 Anchor Pin
- 2 Pcs. - L1417 Shoe Retainer Spring
- 1 Pc. - L1418 Shoe Return Spring
- 2 Pcs. - L1498 Anchor Pin Spider Bushing
- 2 Pcs. - L1537 Roller Retainer

Contains parts to service one wheel.

Same as K117 except: uses L149 rollers in place of L1533 knurled rollers



Schematic
Diagram
Charts

4

K70A

For Dexter 16-1/2" Quick Maintenance
Type Brakes using Standard Duty
Return Spring.

Kit Contains:

- 2 Pcs. - L149 Roller
- 2 Pcs. - L324 Return Spring Pin
- 2 Pcs. - L1416 Anchor Pin
- 2 Pcs. - L1417 Shoe Retainer Spring
- 1 Pc. - L1418 Shoe Return Spring
- 2 Pcs. - L1537 Roller Retainer

Contains parts to service one wheel.

Same as K70 except: does not contain L1498 anchor pin bushings.



K117

For Dexter 16-1/2" Quick Maintenance
Type Brakes using Standard Duty
Return Spring.

Kit Contains:

- 2 Pcs. - L324 Return Spring Pin
- 2 Pcs. - L1416 Anchor Pin
- 2 Pcs. - L1417 Shoe Retainer Spring
- 1 Pc. - L1418 Shoe Return Spring
- 2 Pcs. - L1498 Anchor Pin Spider Bushing
- 2 Pcs. - L1533 Knurled Roller
- 2 Pcs. - L1537 Roller Retainer

Contains parts to service one wheel.

Same as K70 except: uses L1533 knurled rollers in place of L149 Rollers.



DEXTER

BRAKE REPAIR KITS

DEXTER

STANDARD DUTY

K303

For Dexter 16-1/2" Quick Maintenance Type Brakes using Standard Duty Return Spring.

Kit Contains:

- 2 Pcs. - L149 Roller
- 2 Pcs. - L324 Return Spring Pin
- 2 Pcs. - L1417 Retainer Spring
- 1 Pc. - L1418 Return Spring
- 2 Pcs. - L1537 Roller Retainer

Contains parts to service one wheel.
Same as K70 minus L1416 anchor pins and L1498 anchor pin bushings.



Schematic
Diagram
Charts

4

K306

For Dexter 16-1/2" Quick Maintenance Type Brakes using Standard Duty Return Spring.

Kit Contains:

- 2 Pcs. - L149 Roller
- 2 Pcs. - L324 Return Spring Pin
- 2 Pcs. - L888 Anchor Pin Bushing
- 2 Pcs. - L1416 Anchor Pin
- 2 Pcs. - L1417 Retainer Spring
- 1 Pc. - L1418 Return Spring
- 2 Pcs. - L1537 Roller Retainer

Contains parts to service one wheel.
Same as K70 except L1498 is replaced by L888.

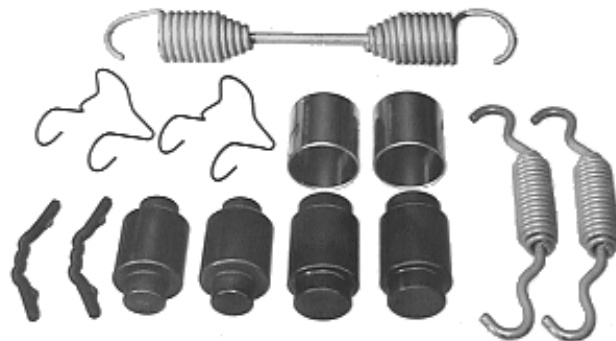

HEAVY DUTY

K128

For Dexter 16-1/2" Quick Maintenance Type Brakes using Heavy Duty Return Spring.

Kit Contains:

- 2 Pcs. - L149 Roller
- 2 Pcs. - L324 Return Spring Pin
- 2 Pcs. - L1416 Anchor Pin
- 2 Pcs. - L1417 Retainer Spring
- 2 Pcs. - L1498 Anchor Pin Bushing
- 2 Pcs. - L1537 Roller Retainer
- 1 Pc. - L2370 HD Return Spring

Contains parts to service one wheel.

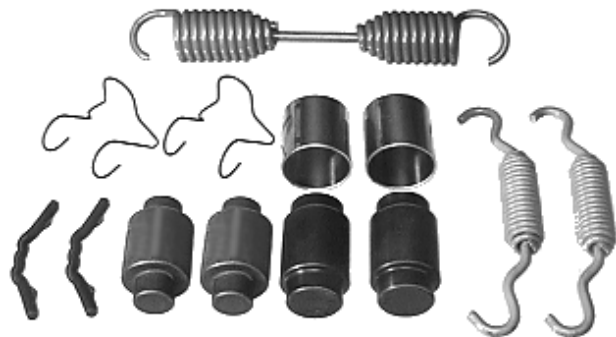

DEXTER

BRAKE REPAIR KITS

DEXTER HEAVY DUTY

K128A

For Dexter 16-1/2" Quick Maintenance
Type Brakes using Heavy Duty
Return Spring.

Kit Contains:

- 2 Pcs. - L149 Roller
- 2 Pcs. - L324 Return Spring Pin
- 2 Pcs. - L1416 Anchor Pin
- 2 Pcs. - L1417 Shoe Retainer Spring
- 2 Pcs. - L1537 Roller Retainer
- 1 Pc. - L2370 HD Return Spring



Contains parts to service one wheel.
Same as K128 except does not contain
L1498 anchor pin bushings.

K128K

For Dexter 16-1/2" Quick Maintenance
Type Brakes using Heavy Duty
Return Spring.

Kit Contains:

- 2 Pcs. - L324 Return Spring Pin
- 2 Pcs. - L1416 Anchor Pin
- 2 Pcs. - L1417 Shoe Retainer Spring
- 2 Pcs. - L1498 Anchor Pin Spider Bushing
- 2 Pcs. - L1533 Knurled Roller
- 2 Pcs. - L1537 Roller Retainer
- 1 Pc. - L2370 Shoe Return Spring



Contains parts to service one wheel.
Same as K70 except L149 roller is replaced by L1533 knurled
roller.

K304

For Dexter 16-1/2" Quick Maintenance
Type Brakes using Heavy Duty
Return Spring.

Kit Contains:

- 2 Pcs. - L149 Roller
- 2 Pcs. - L324 Return Spring Pin
- 2 Pcs. - L1417 Retainer Spring
- 2 Pcs. - L1537 Roller Retainer
- 1 Pc. - L2370 H.D. Return Spring

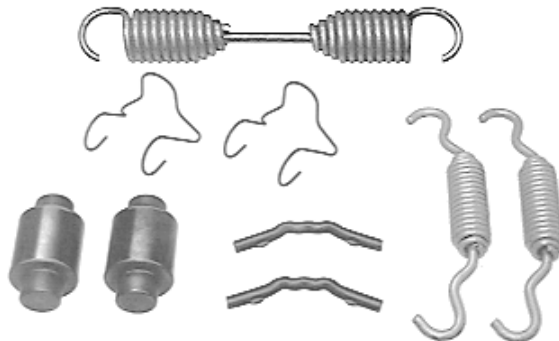

Contains parts to service one wheel.
Same as K128 except does not contain
L1416 anchor pins and L1498 anchor pin bushings.

Schematic
Diagram
Charts

4

DEXTER

 H. D. Version

BRAKE REPAIR KITS

DEXTER

K304K

**For Dexter 16-1/2" Quick Maintenance
Type Brakes using Heavy Duty
Return Spring.**

Kit Contains:

- 2 Pcs. - L324 Return Spring Pin
- 2 Pcs. - L1417 Retainer Spring
- 2 Pcs. - L1537 Roller Retainer
- 2 Pcs. - L1533 Knurled Roller
- 1 Pc. - L2370 H.D. Return Spring

Contains parts to service one wheel.
Same as K303 except L149 smooth roller is replaced
by L1533 knurled roller.

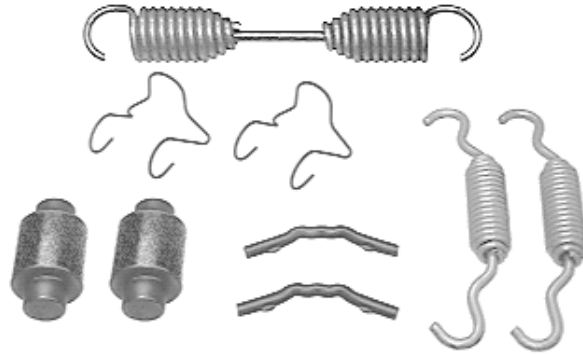

Schematic
Diagram
Charts

4

HEAVY DUTY

K320

**For Dexter 16-1/2" Quick Maintenance
Type Brakes using Heavy Duty
Return Spring.**

Kit Contains:

- 2 Pcs. - L1417 Retainer Spring
- 1 Pc. - L2370 H.D. Return Spring

Contains parts to service one wheel.



K329

**For Dexter 16-1/2" Quick Maintenance
Type Brakes using Heavy Duty
Return Spring.**

Kit Contains:

- 2 Pcs. - L151 Roller Retainer
- 2 Pcs. - L324 Return Spring Pin
- 2 Pcs. - L888 Anchor Pin Spider Bushing
- 2 Pcs. - L1416 Anchor Pin
- 2 Pcs. - L1417 Shoe Retainer Spring
- 2 Pcs. - L1533 Knurled Roller
- 1 Pc. - L2370 Shoe Return Spring

Contains parts to service one wheel.
Same as K128K except L1537 is replaced by
L151 and L1498 is replaced by L888.



**D
E
X
T
E
R**

 **H. D. Version**

CAM REPAIR KITS

DEXTER

K332

For Dexter 16-1/2" Quick Maintenance
Type Brakes using Heavy Duty
Return Spring.

Kit Contains:

- 2 Pcs. - L149 Roller
- 2 Pcs. - L151 Roller Retainer
- 2 Pcs. - L324 Return Spring Pin
- 2 Pcs. - L888 Anchor Pin Spider Bushing
- 2 Pcs. - L1416 Anchor Pin
- 2 Pcs. - L1417 Shoe Retainer Spring
- 1 Pc. - L2370 Shoe Return Spring



Contains parts to service one wheel.
Same as K128 except L1537 is replaced by
L151 and L1498 is replaced by L888.

Schematic
Diagram
Charts

4

K343

Axle Kit for Dexter Late 16-1/2"
Brakes using Nylon Spider Bushing.
Services 10 or 28 Spline, 1-1/2" Cam,
Standard and "Hi-Rise" Types.

Contents:

- 4 Pcs. - L137 Lock Ring
- 2 Pcs. - L193 Spacer Washer
- 2 Pcs. - L344 Spacer Washer
- 2 Pcs. - L397 Lock Ring (28 Spline End)
- 2 Pcs. - L889 Spacer Washer (28 Spline End)
- 4 Pcs. - L966 Neoprene Seal
- 2 Pcs. - L1371 Spacer Washer
- 2 Pcs. - L1536 Nylon Spider Bushing
- 2 Pcs. - L3146 Cam Bracket Bushing



Use **K314** to service One Wheel End.

K348

Axle Kit for Dexter Late 16-1/2"
Brakes using Bronze Spider Bushing.
Services 10 or 28 Spline, 1-1/2" Cam,
Standard and "Hi-Rise" Types.

Contents:

- 4 Pcs. - L137 Lock Ring
- 2 Pcs. - L192 Spacer Washer
- 2 Pcs. - L193 Spacer Washer
- 2 Pcs. - L397 Lock Ring (28 Spline End)
- 2 Pcs. - L402 Bronze Spider Bushing
- 2 Pcs. - L889 Spacer Washer (28 Spline End)
- 4 Pcs. - L966 Neoprene Seal
- 2 Pcs. - L3146 Cam Bracket Bushing



Use **K327** to service One Wheel End.

DEXTER